

SECAP for Construction of Collective Marketing Centres under MLAMP, MBMA for East Jaintia Hills

Appendix I: Checklist – Social, Environmental, and Climate risk screening

District: East Jaintia Hills, Meghalaya	Block: 1. Khliehriat	Integrated Village Cooperative Societies (IVCS): Khliehriat 1. There will be 3 nos. of CMCs in this block	Date: 21 st October 2024		
Name of activity: Construction of Collective Marketing Centres (CMCs). Following will be the activities for each CMCs 1. Construction of CMC with storage: Area is 431 Sq. ft 2. Toilet: Area is 132 Sq. ft					
Name of the beneficiary or group: The beneficiaries will be the IVCS, farmers, CBOs, traders, among others					
Objective and usage of the CMCs: 1. The Collective Marketing Centres (CMC) is the primary farmgate infrastructure being set up under the M-LAMP to be the nodes for aggregation, processing and marketing of produce in the villages and clusters under the project 2. The CMC is a place for marketing of agricultural produce, in addition to being an input supply unit. The basic infrastructure will comprise of a collection space, drying area, retail area, storage area, office space and toilets. Other farm gate infrastructure like cold storage and food processing facilities will be set up in phase II based on need and performance of the CMC 3. The CMC is a one stop shop at the village level, which is co-owned by the members of the Integrated Village Cooperative Society (IVCS)/ Community Based Organisation (CBOs) who have contributed to this project 4. Create an awareness in the process of collective marketing and its merits 5. Initiate the system of aggregation and value addition at village Level 6. Ensure a transparent and good governance for marketing of produce by a collective 7. Enhance the skills of the stakeholder in areas of marketing and financial linkages					
Location of the CMCs:					
Sl. No	NAME OF DISTRICT	NAME OF BLOCK	IVCS	Latitude	Longitude
1	East Jaintia Hills	Khliehriat	Cham Cham IVCS	25.362412	92.232237
2	East Jaintia Hills	Khliehriat	Samasi IVCS	25.401080	92.546906
3	East Jaintia Hills	Khliehriat	Byrwai IVCS	25.432862	92.401844
Issue		Yes/No	If yes, suggest mitigation or adaptation measures to include in plan		Responsibility
Social					
Are there any project targeted beneficiaries left?		No	The establishment of the CMCs will serve as an aggregation point for the village/community for all their agriculture produce. The CMCs will include all the beneficiaries such as IVCS,		1. Executive committee of the CMCs

		farmers, CBOs, traders, among others	
Do the proposed location and/or activities involve child or forced labour?	No	The activities will not involve any forced labour since the standard procurement process is being followed. There is a clause in the tender document which does not permit child labour and the contractor has to adhere to it	1. DPMU 2. Executive committee of the CMC 3. Contractor
Is there any record of labour health and safety at the proposed location and/or activities?	No	The activity will be done through an open tendering process and there is already a clause in the tender document that the contractor has to adhere to the health and safety of the labours being engaged	1. Contractor
Is private or public land acquisition necessary?	Yes	The location of the CMC is in existing community land. The permission/NOC from the local authorities/Dorbars shnong for utilization of the land for the construction of the CMCs is already obtained and available	1. SPMU 2. DPMU
Will any tangible or intangible cultural heritage will be impacted?	No	There is no cultural heritage that will be impacted by this activity	1. SPMU 2. DPMU
Environmental			
Does this activity increased use of chemical inputs?	No	This is a minor civil work and will not include any usage of chemical inputs 1. Construction of CMC with storage: Area is 431 Sq. ft 2. Toilet: Area is 132 Sq. ft	1. Contractor
Will there be issues with wastage management?	Yes	There will be minimal impact with the waste management due to the size of the structure and the facility will be used only for storage of dry items including the aggregation point for the beneficiaries. However, the mitigation measures are: i. Septic Tank and soak pit as budgeted in the BOQ ii. Huge dustbins will be placed in certain areas in the CMCs for the waste to be dumped iii. There is a vehicle arranged by the CMC committee to collect the dustbins every day or as per need iv. Any other requirements will be taken care through the cost of the additional contingencies as budgeted in the BOQ for this activity	1. DPMU 2. Executive committee of the CMC 3. Contractor

Will this activity increase pressure on water and forest resources?	No	The construction of the CMC is at a minor scale and does not cause any depletion and/or reduced flow of groundwater and/or surface water or impact any forest resources	<ol style="list-style-type: none"> 1. DPMU 2. Executive committee of the CMC 3. Contractor
Are the proposed activities near or within a conservation or protected area?	No	The CMC is not near or within a conservation or protected area. The location of the CMC is in existing community land. The permission/NOC from the local authorities/Dorbars shnong for utilization of the land for the construction of the CMCs is already obtained and available	<ol style="list-style-type: none"> 1. DPMU 2. Executive committee of the CMC 3. Contractor
Climate			
Are the proposed activities exposed to impacts of climate change such as increasing temperature, pest and diseases, erratic rainfall etc?	Yes	<p>There is minimal impact, but due to the climatic conditions of the region following may be expected:</p> <ol style="list-style-type: none"> i. During summer the temperature may reach up to 28 deg. C. However, this sub-project also includes a storage facility, hence cold storages may be installed in future as per the requirements ii. Heavy Rainfall is expected during the monsoon season and the roof of the infrastructure will be a slanting-type design so that water will not be accumulated during rainy season. However, proper drainage facility will be constructed as per the requirement which is budgeted through the additional contingencies in the BOQ. Retaining walls may also be constructed if the need arises 	<ol style="list-style-type: none"> 1. DPMU 2. Executive committee of the CMC 3. Contractor
Are the proposed activities located in or near to climate hotspots (river bank, landslide or erosion areas)?	No	The construction of the CMC is not located in or near to climate hotspots (river bank, landslide or erosion areas)	<ol style="list-style-type: none"> 1. DPMU 2. Executive committee of the CMC

ESCMP Matrix of Construction of Collective Marketing Centers (CMCs)

Environment Aspects or Project Activities	Civil work/ Project activities	Potential Environmental/Social impacts	Mitigation/ Remedial Measures	Costs	Institutional Responsibility			
					Responsibility	Monitoring Action/ Indicator	Supervision	Frequency of implementation and/or monitoring
Natural Resources	Construction of: 1. Construction of CMC with storage: Area is 431 Sq. ft 2. Toilet facility: Area is 132 Sq. ft	1. Development happening in areas where little up-to-date information exists on sustainable yield/carrying capacity 2. Sub-project rely on surface water	1. The availability of the CMCs in this area will address the problem of carrying capacity and meet the increasing demand in agricultural produce and sustain the livelihood of the people 2. The construction of the CMC is at a minor scale and does	Design costs	Contractor ED, Technical, MBMA DPMU	1. Assessment on the new infrastructure to be build. To increase the facilities of the infrastructure if there are further requirements 2. Availability of water during the construction	ED - Technical, MBMA	During the construction phase and after the CMC is operational

			not cause any depletion and/or reduced flow of groundwater and/or surface water					
Climate Change Adaptation	<ol style="list-style-type: none"> 1. Use of climate-resilient design and materials 2. Elevated structures and collection space, drying area, retail area, office space facilities 3. Energy-efficient lighting and appliances 4. Storage facility 	<ol style="list-style-type: none"> 1. During summer the temperature may reached up to 35 deg. C 2. Heavy rainfall is expected during the monsoon season 	<ol style="list-style-type: none"> 1. Construction of a storage and drying area facility is part of the sub-project. Hence cold storages may be installed in future as per the requirements 2. The roof of the infrastructure will be a slanting-type design so that water 	Design costs	<ol style="list-style-type: none"> 1. ED, Technical - MBMA 2. Contractor 3. DPMU - MLAMP 	<ol style="list-style-type: none"> 1. Regular inspection of materials and infrastructures 	ED - Technical , MBMA	Prior and during the construction phase

			will not be accumulated during rainy season					
Human Rights	1. Fair labour practices 2. Accessibility for all vendors and customers	1. Labor exploitation 2. Discrimination	1. Implement fair wage policies 2. Ensure accessibility for people with disabilities	Design costs	IVCS committee	1. Labor audits 2. Accessibility checks	1. DPMU - MBMA 2. IVCS Committee	Prior and during the construction phase and after the market is operational
Health and Safety	1. Safe construction practices 2. Health facilities for market users	Occupational health and safety hazards to construction personnel & public	1. Provide safety training and equipment 2. Ensure availability of health services	Design costs	1. Contractor 2. MLAMP - DPMU	1. Incident reports 2. Health service utilization	1. Contractor 2. MLAMP - DPMU	Prior and during the construction phase and after the market is operational

Master Plan and Drawing of the CMC:

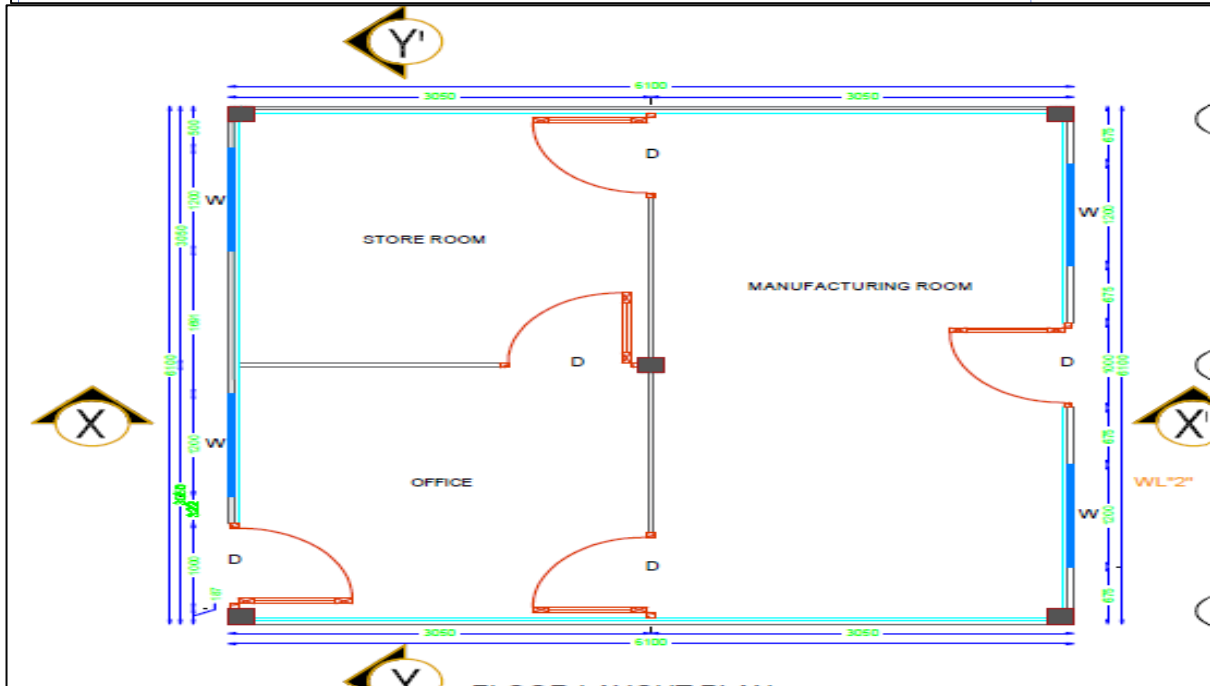
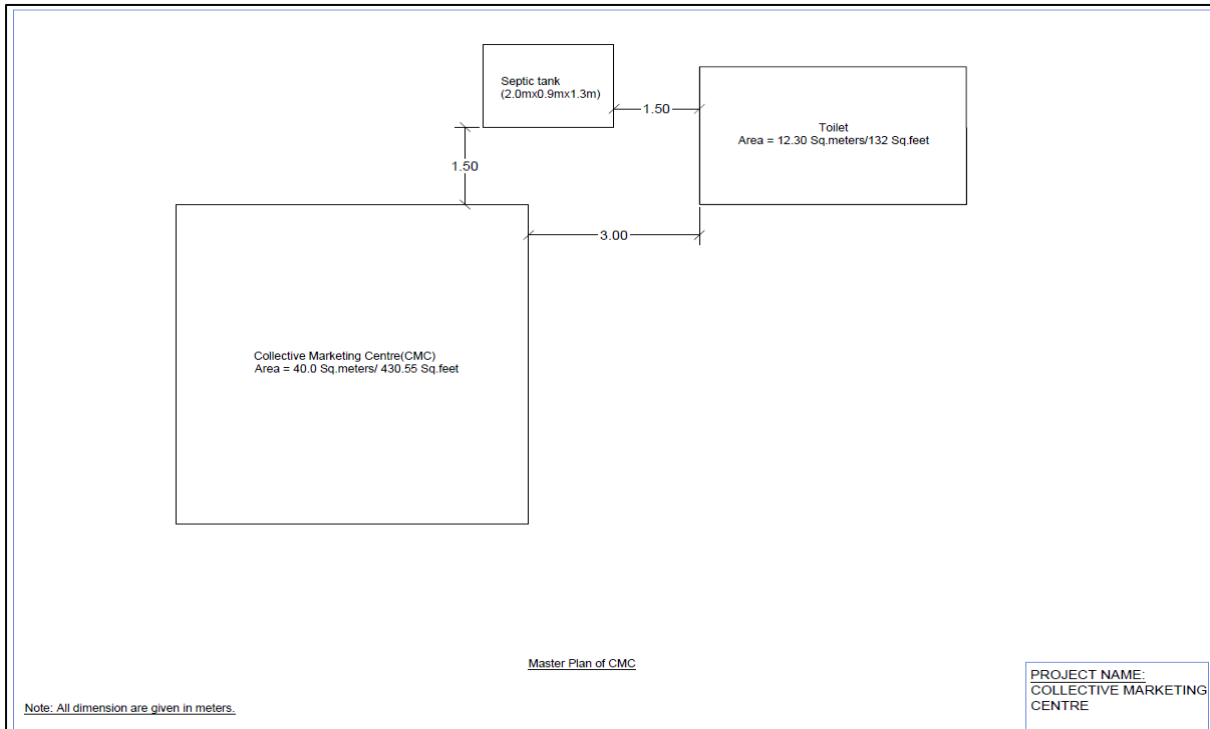

SECAP for Construction of Collective Marketing Centres under MLAMP, MBMA for East Khasi Hills

Appendix I: Checklist – Social, Environmental, and Climate risk screening

District: East Khasi Hills, Meghalaya	Block: 1. Mawsynram 2. Myllem 3. Mawryngkneng 4. Pynursla 5. Mawkynrew 6. Mawlai	Integrated Cooperative Societies (IVCS): Mawsynram 1. There will be 1 nos. of CMCs in this block Myllem 1. There will be 1 nos. of CMCs in this block Mawryngkneng 1. There will be 2 nos. of CMCs in this block Pynursla 1. There will be 2 nos. of CMCs in this block Mawkynrew 1. There will be 2 nos. of CMCs in this block Mawlai 1. There will be 1 nos. of CMCs in this block	Village Societies Date: 21 st October 2024
Name of activity: Construction of Collective Marketing Centres (CMCs). Following will be the activities for each CMCs 1. Construction of CMC with storage: Area is 431 Sq. ft 2. Toilet: Area is 132 Sq. ft			
Name of the beneficiary or group: The beneficiaries will be the IVCS, farmers, CBOs, traders, among others			
Objective and usage of the CMCs: 1. The Collective Marketing Centres (CMC) is the primary farmgate infrastructure being set up under the M-LAMP to be the nodes for aggregation, processing and marketing of produce in the villages and clusters under the project			

2. The CMC is a place for marketing of agricultural produce, in addition to being an input supply unit. The basic infrastructure will comprise of a collection space, drying area, retail area, storage area, office space and toilets. Other farm gate infrastructure like cold storage and food processing facilities will be set up in phase II based on need and performance of the CMC
3. The CMC is a one stop shop at the village level, which is co-owned by the members of the Integrated Village Cooperative Society (IVCS)/ Community Based Organisation (CBOs) who have contributed to this project
4. Create an awareness in the process of collective marketing and its merits
5. Initiate the system of aggregation and value addition at village Level
6. Ensure a transparent and good governance for marketing of produce by a collective
7. Enhance the skills of the stakeholder in areas of marketing and financial linkages

Location of the CMCs:

Sl. No	NAME OF DISTRICT	NAME OF BLOCK	IVCS	Latitude	Longitude
1	East Khasi Hills	Mawsynram	Mawkasain IVCS	25.265337	91.518527
2	East Khasi Hills	Mylliem	Rangbihbih IVCS	25.4983	91.8767
3	East Khasi Hills	Mawryngkneng	Mawiong IVCS	25.6793	92.02961
4	East Khasi Hills	Mawryngkneng	Puriang IVCS	25.540872	92.09438
5	East Khasi Hills	Pynursla	Pynter IVCS	25.26324	91.962562
6	East Khasi Hills	Pynursla	Wahkdait IVCS	25.20771	91.987267
7	East Khasi Hills	Mawkynew	Jatah Nonglyer IVCS	25.413687	92.056869
8	East Khasi Hills	Mawkynew	Laitkyrhong IVCS	25.463793	91.899101
9	East Khasi Hills	Mawlai	Iaryntihlang FACT IVCS	25.6869066	91.966895

Issue	Yes/No	If yes, suggest mitigation or adaptation measures to include in plan	Responsibility
-------	--------	--	----------------

Social

Are there any project targeted beneficiaries left?	No	The establishment of the CMCs will serve as an aggregation point for the village/community for all their agriculture produce. The CMCs will include all the beneficiaries such as IVCS, farmers, CBOs, traders, among others	1. Executive committee of the CMCs
Do the proposed location and/or activities involve child or forced labour?	No	The activities will not involve any forced labour since the standard procurement process is being followed. There is a clause in the tender document which does not permit child labour and the contractor has to adhere to it	1. DPMU 2. Executive committee of the CMC 3. Contractor
Is there any record of labour health and safety at the proposed location and/or activities?	No	The activity will be done through an open tendering process and there is already a clause in the tender document that the contractor has to adhere to the health and safety of the labours being engaged	1. Contractor

Is private or public land acquisition necessary?	Yes	The location of the CMC is in existing community land. The permission/NOC from the local authorities/Dorbars shnong for utilization of the land for the construction of the CMCs is already obtained and available	1. SPMU 2. DPMU
Will any tangible or intangible cultural heritage will be impacted?	No	There is no cultural heritage that will be impacted by this activity	1. SPMU 2. DPMU
Environmental			
Does this activity increase use of chemical inputs?	No	This is a minor civil work and will not include any usage of chemical inputs 1. Construction of CMC with storage: Area is 431 Sq. ft 2. Toilet: Area is 132 Sq. ft	1. Contractor
Will there be issues with wastage management?	Yes	There will be minimal impact with the waste management due to the size of the structure and the facility will be used only for storage of dry items including the aggregation point for the beneficiaries. However, the mitigation measures are: i. Septic Tank and soak pit as budgeted in the BOQ ii. Huge dustbins will be placed in certain areas in the CMCs for the waste to be dumped iii. There is a vehicle arranged by the CMC committee to collect the dustbins every day or as per need iv. Any other requirements will be taken care through the cost of the additional contingencies as budgeted in the BOQ for this activity	1. DPMU 2. Executive committee of the CMC 3. Contractor
Will this activity increase pressure on water and forest resources?	No	The construction of the CMC is at a minor scale and does not cause any depletion and/or reduced flow of groundwater and/or surface water or impact any forest resources	1. DPMU 2. Executive committee of the CMC 3. Contractor
Are the proposed activities near or within a conservation or protected area?	No	The CMC is not near or within a conservation or protected area. The location of the CMC is in existing community land. The permission/NOC from the local authorities/Dorbars shnong for utilization of the land for the construction of the CMCs is already obtained and available	1. DPMU 2. Executive committee of the CMC 3. Contractor
Climate			

<p>Are the proposed activities exposed to impacts of climate change such as increasing temperature, pest and diseases, erratic rainfall etc?</p>	<p>Yes</p>	<p>There is minimal impact, but due to the climatic conditions of the region following may be expected:</p> <ul style="list-style-type: none"> i. During summer the temperature may reach up to 28 deg. C. However, this sub-project also includes a storage facility, hence cold storages may be installed in future as per the requirements ii. Heavy Rainfall is expected during the monsoon season and the roof of the infrastructure will be a slanting-type design so that water will not be accumulated during rainy season. However, proper drainage facility will be constructed as per the requirement which is budgeted through the additional contingencies in the BOQ. Retaining walls may also be constructed if the need arises 	<ul style="list-style-type: none"> 1. DPMU 2. Executive committee of the CMC 3. Contractor
<p>Are the proposed activities located in or near to climate hotspots (river bank, landslide or erosion areas)?</p>	<p>No</p>	<p>The construction of the CMC is not located in or near to climate hotspots (river bank, landslide or erosion areas)</p>	<ul style="list-style-type: none"> 1. DPMU 2. Executive committee of the CMC

ESCMP Matrix of Construction of Collective Marketing Centers (CMCs)

Environment Aspects or Project Activities	Civil work/ Project activities	Potential Environmental/Social impacts	Mitigation/ Remedial Measures	Costs	Institutional Responsibility			
					Responsibility	Monitoring Action/ Indicator	Supervision	Frequency of implementation and/or monitoring
Natural Resources	Construction of: 1. Construction of CMC with storage: Area is 431 Sq. ft 2. Toilet facility: Area is 132 Sq. ft	1. Development happening in areas where little up-to-date information exists on sustainable yield/carrying capacity 2. Sub-project rely on surface water	1. The availability of the CMCs in this area will address the problem of carrying capacity and meet the increasing demand in agricultural produce and sustain the livelihood of the people 2. The construction of the CMC is at a minor scale and does	Design costs	Contractor ED, Technical, MBMA DPMU	1. Assessment on the new infrastructure to be build. To increase the facilities of the infrastructure if there are further requirements 2. Availability of water during the construction	ED - Technical, MBMA	During the construction phase and after the CMC is operational

			not cause any depletion and/or reduced flow of groundwater and/or surface water					
Climate Change Adaptation	<ol style="list-style-type: none"> 1. Use of climate-resilient design and materials 2. Elevated structures and collection space, drying area, retail area, office space facilities 3. Energy-efficient lighting and appliances 4. Storage facility 	<ol style="list-style-type: none"> 1. During summer the temperature may reached up to 35 deg. C 2. Heavy rainfall is expected during the monsoon season 	<ol style="list-style-type: none"> 1. Construction of a storage and drying area facility is part of the sub-project. Hence cold storages may be installed in future as per the requirements 2. The roof of the infrastructure will be a slanting-type design so that water 	Design costs	<ol style="list-style-type: none"> 1. ED, Technical - MBMA 2. Contractor 3. DPMU - MLAMP 	<ol style="list-style-type: none"> 1. Regular inspection of materials and infrastructure 	ED - Technical , MBMA	Prior and during the construction phase

			will not be accumulated during rainy season					
Human Rights	1. Fair labour practices 2. Accessibility for all vendors and customers	1. Labor exploitation 2. Discrimination	1. Implement fair wage policies 2. Ensure accessibility for people with disabilities	Design costs	IVCS committee	1. Labor audits 2. Accessibility checks	1. DPMU - MBMA 2. IVCS Committee	Prior and during the construction phase and after the market is operational
Health and Safety	1. Safe construction practices 2. Health facilities for market users	Occupational health and safety hazards to construction personnel & public	1. Provide safety training and equipment 2. Ensure availability of health services	Design costs	1. Contractor 2. MLAMP - DPMU	1. Incident reports 2. Health service utilization	1. Contractor 2. MLAMP - DPMU	Prior and during the construction phase and after the market is operational

Master Plan and Drawing of the CMC:

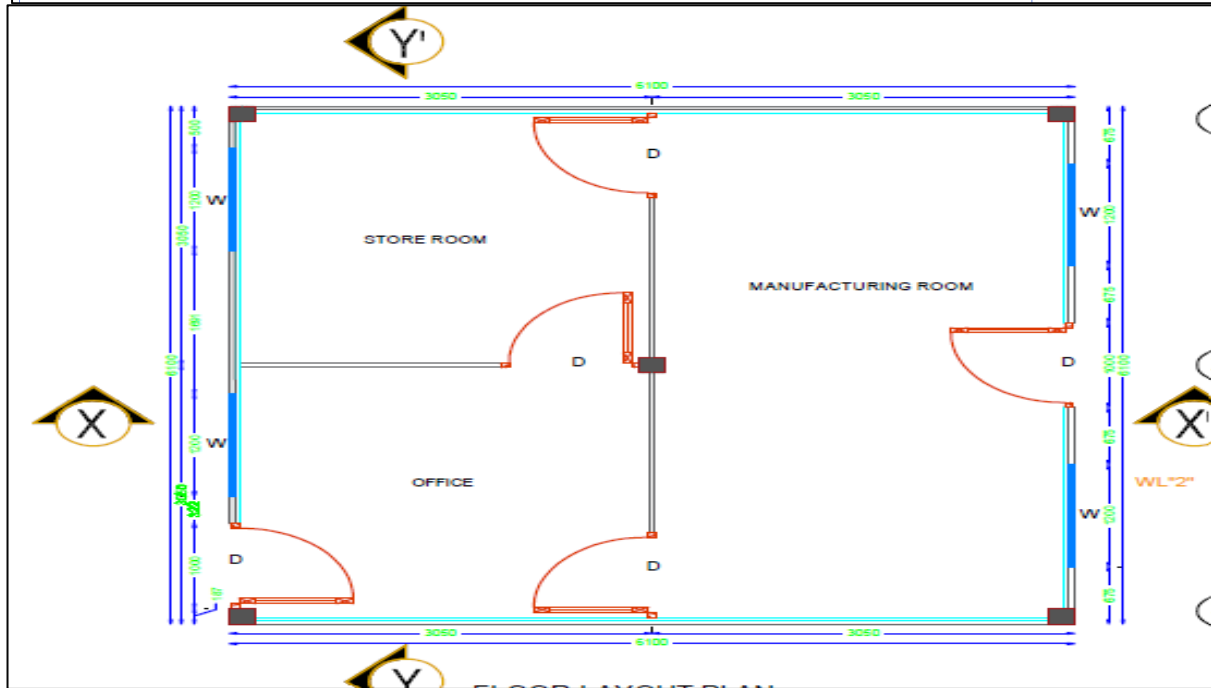
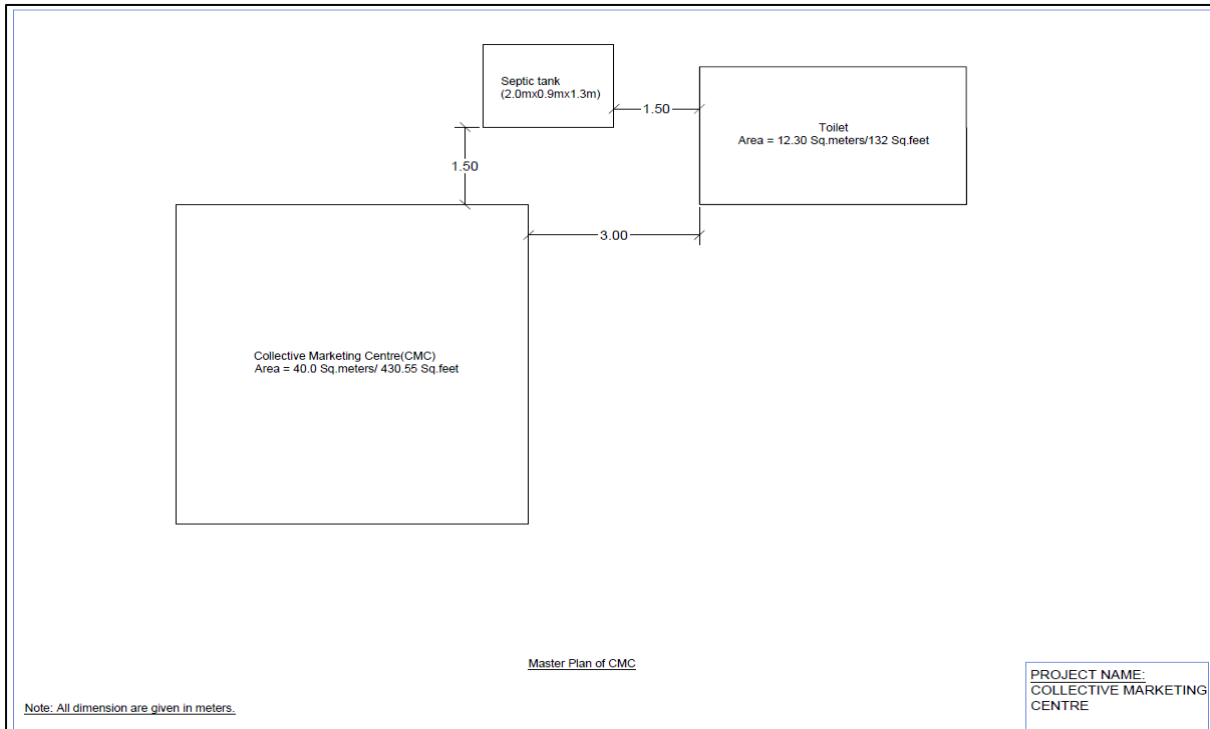

SECAP for Construction of Collective Marketing Centres under MLAMP, MBMA for Eastern West Khasi Hills

Appendix I: Checklist – Social, Environmental, and Climate risk screening

District: Eastern West Khasi Hills, Meghalaya	Block: 1. Mairang	Integrated Village Cooperative Societies (IVCS): Mairang There will be 1 nos. of CMCs in this block	Date: 21 st October 2024		
Name of activity: Construction of Collective Marketing Centres (CMCs). Following will be the activities for each CMCs 1. Construction of CMC with storage: Area is 431 Sq. ft 2. Toilet: Area is 132 Sq. ft					
Name of the beneficiary or group: The beneficiaries will be the IVCS, farmers, CBOs, traders, among others					
Objective and usage of the CMCs: 1. The Collective Marketing Centres (CMC) is the primary farmgate infrastructure being set up under the M-LAMP to be the nodes for aggregation, processing and marketing of produce in the villages and clusters under the project 2. The CMC is a place for marketing of agricultural produce, in addition to being an input supply unit. The basic infrastructure will comprise of a collection space, drying area, retail area, storage area, office space and toilets. Other farm gate infrastructure like cold storage and food processing facilities will be set up in phase II based on need and performance of the CMC 3. The CMC is a one stop shop at the village level, which is co-owned by the members of the Integrated Village Cooperative Society (IVCS)/ Community Based Organisation (CBOs) who have contributed to this project 4. Create an awareness in the process of collective marketing and its merits 5. Initiate the system of aggregation and value addition at village Level 6. Ensure a transparent and good governance for marketing of produce by a collective 7. Enhance the skills of the stakeholder in areas of marketing and financial linkages					
Location of the CMCs:					
Sl. No	NAME OF DISTRICT	NAME OF BLOCK	IVCS	Latitude	Longitude
1	Eastern West Khasi Hills	Mairang	Nongrmai IVCS	25.616336	91.618149
Issue		Yes/No	If yes, suggest mitigation or adaptation measures to include in plan	Responsibility	
Social					
Are there any project targeted beneficiaries left?		No	The establishment of the CMCs will serve as an aggregation point for the village/community for all their agriculture produce. The CMCs will include all the beneficiaries such as IVCS, farmers, CBOs, traders, among others	1. Executive committee of the CMCs	

Do the proposed location and/or activities involve child or forced labour?	No	The activities will not involve any forced labour since the standard procurement process is being followed. There is a clause in the tender document which does not permit child labour and the contractor has to adhere to it	<ol style="list-style-type: none"> 1. DPMU 2. Executive committee of the CMC 3. Contractor
Is there any record of labour health and safety at the proposed location and/or activities?	No	The activity will be done through an open tendering process and there is already a clause in the tender document that the contractor has to adhere to the health and safety of the labours being engaged	<ol style="list-style-type: none"> 1. Contractor
Is private or public land acquisition necessary?	Yes	The location of the CMC is in existing community land. The permission/NOC from the local authorities/Dorbars shnong for utilization of the land for the construction of the CMCs is already obtained and available	<ol style="list-style-type: none"> 1. SPMU 2. DPMU
Will any tangible or intangible cultural heritage will be impacted?	No	There is no cultural heritage that will be impacted by this activity	<ol style="list-style-type: none"> 1. SPMU 2. DPMU
Environmental			
Does this activity increased use of chemical inputs?	No	<p>This is a minor civil work and will not include any usage of chemical inputs</p> <ol style="list-style-type: none"> 1. Construction of CMC with storage: Area is 431 Sq. ft 2. Toilet: Area is 132 Sq. ft 	<ol style="list-style-type: none"> 1. Contractor
Will there be issues with wastage management?	Yes	<p>There will be minimal impact with the waste management due to the size of the structure and the facility will be used only for storage of dry items including the aggregation point for the beneficiaries. However, the mitigation measures are:</p> <ol style="list-style-type: none"> i. Septic Tank and soak pit as budgeted in the BOQ ii. Huge dustbins will be placed in certain areas in the CMCs for the waste to be dumped iii. There is a vehicle arranged by the CMC committee to collect the dustbins every day or as per need iv. Any other requirements will be taken care through the cost of the additional contingencies as budgeted in the BOQ for this activity 	<ol style="list-style-type: none"> 1. DPMU 2. Executive committee of the CMC 3. Contractor
Will this activity increase pressure on water and forest resources?	No	The construction of the CMC is at a minor scale and does not cause any depletion and/or reduced flow of groundwater and/or	<ol style="list-style-type: none"> 1. DPMU 2. Executive committee of the CMC

		surface water or impact any forest resources	3. Contractor
Are the proposed activities near or within a conservation or protected area?	No	The CMC is not near or within a conservation or protected area. The location of the CMC is in existing community land. The permission/NOC from the local authorities/Dorbars shnong for utilization of the land for the construction of the CMCs is already obtained and available	1. DPMU 2. Executive committee of the CMC 3. Contractor
Climate			
Are the proposed activities exposed to impacts of climate change such as increasing temperature, pest and diseases, erratic rainfall etc?	Yes	There is minimal impact, but due to the climatic conditions of the region following may be expected: i. During summer the temperature may reach up to 28 deg. C. However, this sub-project also includes a storage facility, hence cold storages may be installed in future as per the requirements ii. Heavy Rainfall is expected during the monsoon season and the roof of the infrastructure will be a slanting-type design so that water will not be accumulated during rainy season. However, proper drainage facility will be constructed as per the requirement which is budgeted through the additional contingencies in the BOQ. Retaining walls may also be constructed if the need arises	1. DPMU 2. Executive committee of the CMC 3. Contractor
Are the proposed activities located in or near to climate hotspots (river bank, landslide or erosion areas)?	No	The construction of the CMC is not located in or near to climate hotspots (river bank, landslide or erosion areas)	1. DPMU 2. Executive committee of the CMC

ESCMP Matrix of Construction of Collective Marketing Centers (CMCs)

Environment Aspects or Project Activities	Civil work/ Project activities	Potential Environmental/Social impacts	Mitigation/ Remedial Measures	Costs	Institutional Responsibility			
					Responsibility	Monitoring Action/ Indicator	Supervision	Frequency of implementation and/or monitoring
Natural Resources	Construction of: 1. Construction of CMC with storage: Area is 431 Sq. ft 2. Toilet facility: Area is 132 Sq. ft	1. Development happening in areas where little up-to-date information exists on sustainable yield/carrying capacity 2. Sub-project rely on surface water	1. The availability of the CMCs in this area will address the problem of carrying capacity and meet the increasing demand in agricultural produce and sustain the livelihood of the people 2. The construction of the CMC is at a minor scale and does	Design costs	Contractor ED, Technical, MBMA DPMU	1. Assessment on the new infrastructure to be build. To increase the facilities of the infrastructure if there are further requirements 2. Availability of water during the construction	ED - Technical, MBMA	During the construction phase and after the CMC is operational

			not cause any depletion and/or reduced flow of groundwater and/or surface water					
Climate Change Adaptation	<ol style="list-style-type: none"> 1. Use of climate-resilient design and materials 2. Elevated structures and collection space, drying area, retail area, office space facilities 3. Energy-efficient lighting and appliances 4. Storage facility 	<ol style="list-style-type: none"> 1. During summer the temperature may reached up to 35 deg. C 2. Heavy rainfall is expected during the monsoon season 	<ol style="list-style-type: none"> 1. Construction of a storage and drying area facility is part of the sub-project. Hence cold storages may be installed in future as per the requirements 2. The roof of the infrastructure will be a slanting-type design so that water 	Design costs	<ol style="list-style-type: none"> 1. ED, Technical - MBMA 2. Contractor 3. DPMU - MLAMP 	<ol style="list-style-type: none"> 1. Regular inspection of materials and infrastructures 	ED - Technical , MBMA	Prior and during the construction phase

			will not be accumulated during rainy season					
Human Rights	1. Fair labour practices 2. Accessibility for all vendors and customers	1. Labor exploitation 2. Discrimination	1. Implement fair wage policies 2. Ensure accessibility for people with disabilities	Design costs	IVCS committee	1. Labor audits 2. Accessibility checks	1. DPMU - MBMA 2. IVCS Committee	Prior and during the construction phase and after the market is operational
Health and Safety	1. Safe construction practices 2. Health facilities for market users	Occupational health and safety hazards to construction personnel & public	1. Provide safety training and equipment 2. Ensure availability of health services	Design costs	1. Contractor 2. MLAMP - DPMU	1. Incident reports 2. Health service utilization	1. Contractor 2. MLAMP - DPMU	Prior and during the construction phase and after the market is operational

Master Plan and Drawing of the CMC:

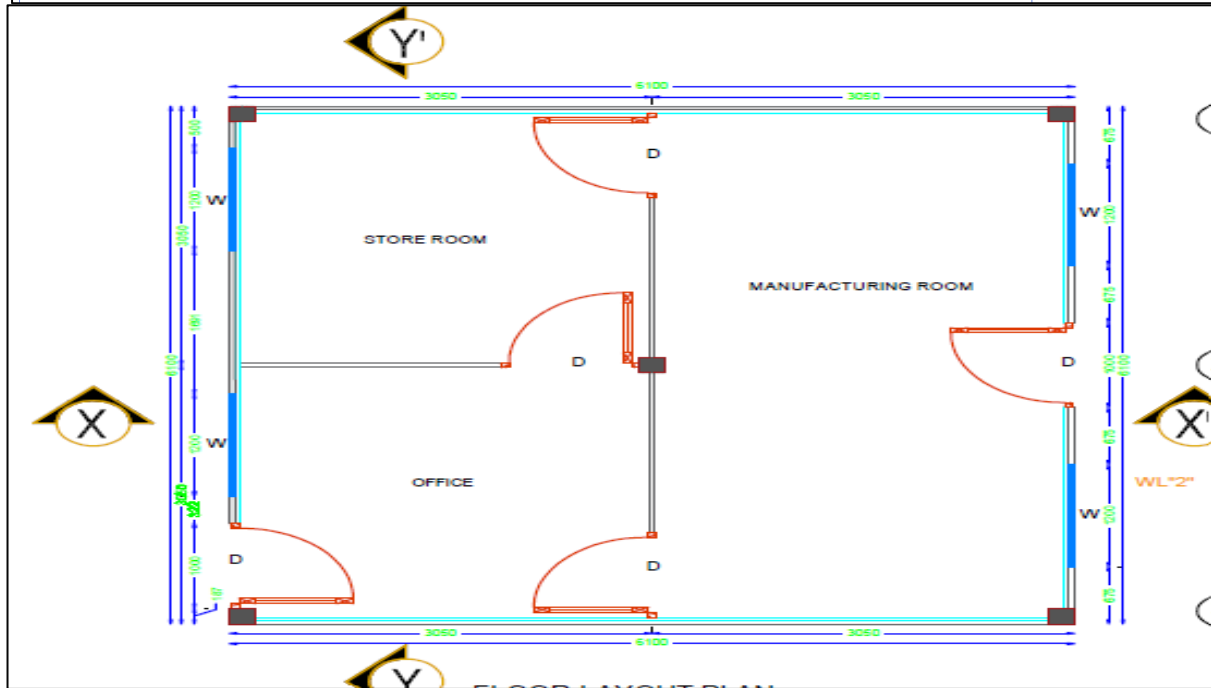
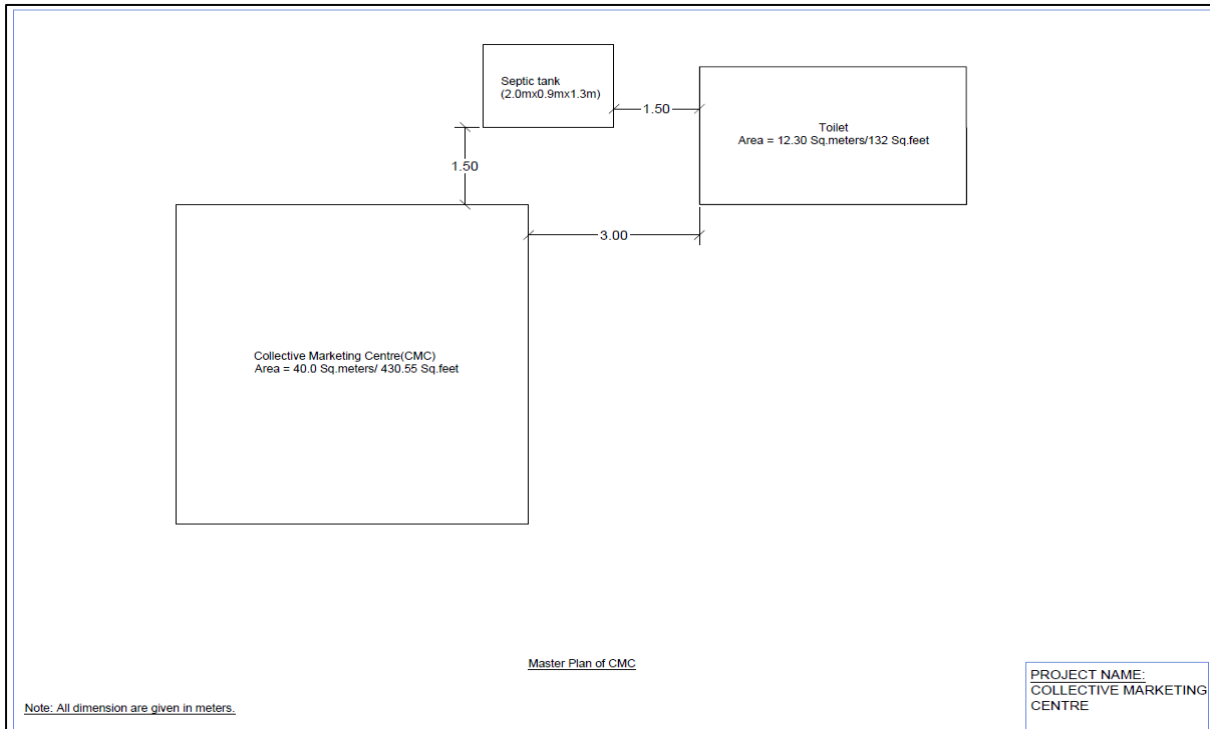

SECAP for Construction of Collective Marketing Centres under MLAMP, MBMA for South Garo Hills

Appendix I: Checklist – Social, Environmental, and Climate risk screening

District: South Garo Hills, Meghalaya	Block: 1. Baghmara 2. Gasuapara 3. Chokpot	Integrated Village Cooperative Societies (IVCS): Baghmara 1. There will be 1 nos. of CMCs in this block Gasuapara 1. There will be 2 nos. of CMCs in this block Chokpot 1. There will be 1 nos. of CMCs in this block	Date: 21 st October 2024		
Name of activity: Construction of Collective Marketing Centres (CMCs). Following will be the activities for each CMCs 1. Construction of CMC with storage: Area is 431 Sq. ft 2. Toilet: Area is 132 Sq. ft					
Name of the beneficiary or group: The beneficiaries will be the IVCS, farmers, CBOs, traders, among others					
Objective and usage of the CMCs: 1. The Collective Marketing Centres (CMC) is the primary farmgate infrastructure being set up under the M-LAMP to be the nodes for aggregation, processing and marketing of produce in the villages and clusters under the project 2. The CMC is a place for marketing of agricultural produce, in addition to being an input supply unit. The basic infrastructure will comprise of a collection space, drying area, retail area, storage area, office space and toilets. Other farm gate infrastructure like cold storage and food processing facilities will be set up in phase II based on need and performance of the CMC 3. The CMC is a one stop shop at the village level, which is co-owned by the members of the Integrated Village Cooperative Society (IVCS)/ Community Based Organisation (CBOs) who have contributed to this project 4. Create an awareness in the process of collective marketing and its merits 5. Initiate the system of aggregation and value addition at village Level 6. Ensure a transparent and good governance for marketing of produce by a collective 7. Enhance the skills of the stakeholder in areas of marketing and financial linkages					
Location of the CMCs:					
Sl. No	NAME OF DISTRICT	NAME OF BLOCK	IVCS	Latitude	Longitude
1	South Garo Hills	Gasuapara	Megua Songma IVCS Ltd.	25.250533	90.288801
2	South Garo Hills	Chokpot	Balwatgre IVCS Ltd.	25.300907	90.442133
3	South Garo Hills	Baghmara	Nongalbibra IVCS	25.46384584	90.70114246

4	South Garo Hills	Gasuapara	Bamonbajra IVCS Ltd.	25.223516	90.482828
Issue					
		Yes/No	If yes, suggest mitigation or adaptation measures to include in plan	Responsibility	
Social					
Are there any project targeted beneficiaries left?		No	The establishment of the CMCs will serve as an aggregation point for the village/community for all their agriculture produce. The CMCs will include all the beneficiaries such as IVCS, farmers, CBOs, traders, among others	1. Executive committee of the CMCs	
Do the proposed location and/or activities involve child or forced labour?		No	The activities will not involve any forced labour since the standard procurement process is being followed. There is a clause in the tender document which does not permit child labour and the contractor has to adhere to it	1. DPMU 2. Executive committee of the CMC 3. Contractor	
Is there any record of labour health and safety at the proposed location and/or activities?		No	The activity will be done through an open tendering process and there is already a clause in the tender document that the contractor has to adhere to the health and safety of the labours being engaged	1. Contractor	
Is private or public land acquisition necessary?		Yes	The location of the CMC is in existing community land. The permission/NOC from the local authorities/Dorbars shnong for utilization of the land for the construction of the CMCs is already obtained and available	1. SPMU 2. DPMU	
Will any tangible or intangible cultural heritage will be impacted?		No	There is no cultural heritage that will be impacted by this activity	1. SPMU 2. DPMU	
Environmental					
Does this activity increased use of chemical inputs?		No	This is a minor civil work and will not include any usage of chemical inputs 1. Construction of CMC with storage: Area is 431 Sq. ft 2. Toilet: Area is 132 Sq. ft	1. Contractor	
Will there be issues with wastage management?		Yes	There will be minimal impact with the waste management due to the size of the structure and the facility will be used only for storage of dry items including the aggregation point for the beneficiaries. However, the mitigation measures are: i. Septic Tank and soak pit as budgeted in the BOQ ii. Huge dustbins will be placed in certain areas in	1. DPMU 2. Executive committee of the CMC 3. Contractor	

		<p>the CMCs for the waste to be dumped</p> <p>iii. There is a vehicle arranged by the CMC committee to collect the dustbins every day or as per need</p> <p>iv. Any other requirements will be taken care through the cost of the additional contingencies as budgeted in the BOQ for this activity</p>	
Will this activity increase pressure on water and forest resources?	No	The construction of the CMC is at a minor scale and does not cause any depletion and/or reduced flow of groundwater and/or surface water or impact any forest resources	<ol style="list-style-type: none"> 1. DPMU 2. Executive committee of the CMC 3. Contractor
Are the proposed activities near or within a conservation or protected area?	No	The CMC is not near or within a conservation or protected area. The location of the CMC is in existing community land. The permission/NOC from the local authorities/Dorbars shnong for utilization of the land for the construction of the CMCs is already obtained and available	<ol style="list-style-type: none"> 1. DPMU 2. Executive committee of the CMC 3. Contractor
Climate			
Are the proposed activities exposed to impacts of climate change such as increasing temperature, pest and diseases, erratic rainfall etc?	Yes	<p>There is minimal impact, but due to the climatic conditions of the region following may be expected:</p> <p>i. During summer the temperature may reach up to 35 deg. C. However, this sub-project also includes a storage facility, hence cold storages may be installed in future as per the requirements</p> <p>ii. Heavy Rainfall is expected during the monsoon season and the roof of the infrastructure will be a slanting-type design so that water will not be accumulated during rainy season. However, proper drainage facility will be constructed as per the requirement which is budgeted through the additional contingencies in the BOQ. Retaining walls may also be constructed if the need arises</p>	<ol style="list-style-type: none"> 1. DPMU 2. Executive committee of the CMC 3. Contractor

Are the proposed activities located in or near to climate hotspots (river bank, landslide or erosion areas)?	No	The construction of the CMC is not located in or near to climate hotspots (river bank, landslide or erosion areas)	<ol style="list-style-type: none"> 1. DPMU 2. Executive committee of the CMC
--	----	--	--

ESCMP Matrix of Construction of Collective Marketing Centers (CMCs)

Environment Aspects or Project Activities	Civil work/ Project activities	Potential Environmental/Social impacts	Mitigation/ Remedial Measures	Costs	Institutional Responsibility			
					Responsibility	Monitoring Action/ Indicator	Supervision	Frequency of implementation and/or monitoring
Natural Resources	Construction of: 1. Construction of CMC with storage: Area is 431 Sq. ft 2. Toilet facility: Area is 132 Sq. ft	1. Development happening in areas where little up-to-date information exists on sustainable yield/carrying capacity 2. Sub-project rely on surface water	1. The availability of the CMCs in this area will address the problem of carrying capacity and meet the increasing demand in agricultural produce and sustain the livelihood of the people 2. The construction of the CMC is at a minor scale and does	Design costs	Contractor ED, Technical, MBMA DPMU	1. Assessment on the new infrastructure to be build. To increase the facilities of the infrastructure if there are further requirements 2. Availability of water during the construction	ED - Technical, MBMA	During the construction phase and after the CMC is operational

			not cause any depletion and/or reduced flow of groundwater and/or surface water					
Climate Change Adaptation	<ol style="list-style-type: none"> 1. Use of climate-resilient design and materials 2. Elevated structures and collection space, drying area, retail area, office space facilities 3. Energy-efficient lighting and appliances 4. Storage facility 	<ol style="list-style-type: none"> 1. During summer the temperature may reached up to 35 deg. C 2. Heavy rainfall is expected during the monsoon season 	<ol style="list-style-type: none"> 1. Construction of a storage and drying area facility is part of the sub-project. Hence cold storages may be installed in future as per the requirements 2. The roof of the infrastructure will be a slanting-type design so that water 	Design costs	<ol style="list-style-type: none"> 1. ED, Technical - MBMA 2. Contractor 3. DPMU - MLAMP 	<ol style="list-style-type: none"> 1. Regular inspection of materials and infrastructure 	ED - Technical , MBMA	Prior and during the construction phase

			will not be accumulated during rainy season					
Human Rights	1. Fair labour practices 2. Accessibility for all vendors and customers	1. Labor exploitation 2. Discrimination	1. Implement fair wage policies 2. Ensure accessibility for people with disabilities	Design costs	IVCS committee	1. Labor audits 2. Accessibility checks	1. DPMU - MBMA 2. IVCS Committee	Prior and during the construction phase and after the market is operational
Health and Safety	1. Safe construction practices 2. Health facilities for market users	Occupational health and safety hazards to construction personnel & public	1. Provide safety training and equipment 2. Ensure availability of health services	Design costs	1. Contractor 2. MLAMP - DPMU	1. Incident reports 2. Health service utilization	1. Contractor 2. MLAMP - DPMU	Prior and during the construction phase and after the market is operational

Master Plan and Drawing of the CMC:

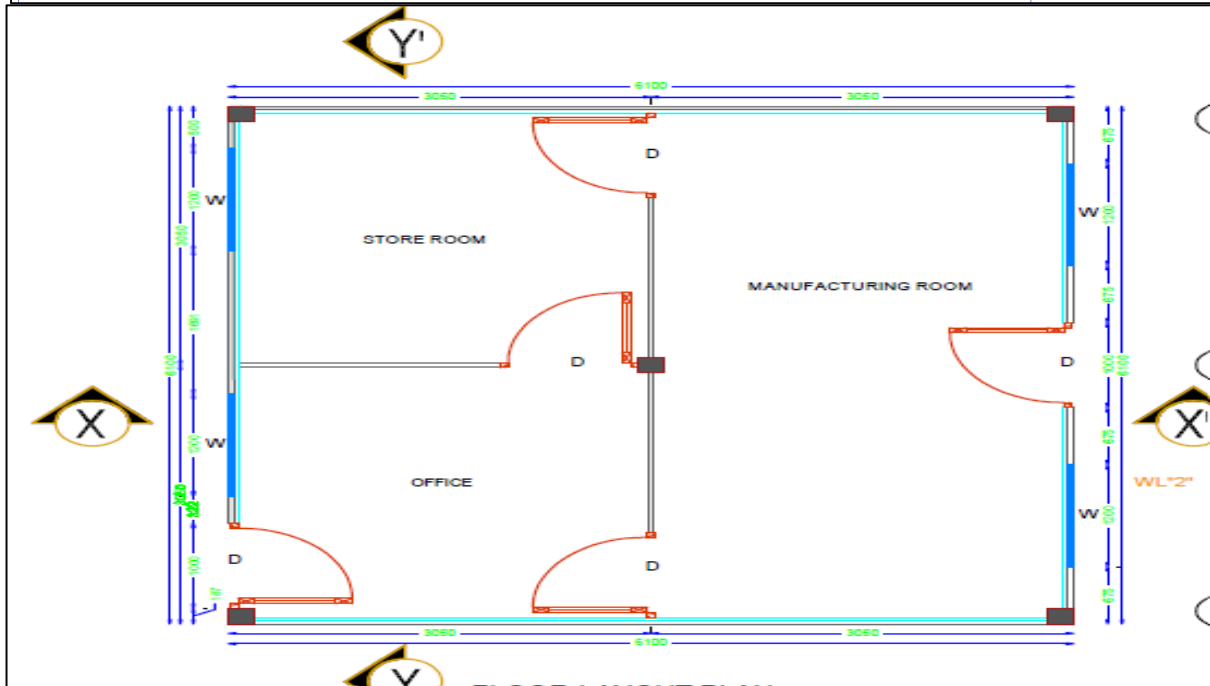
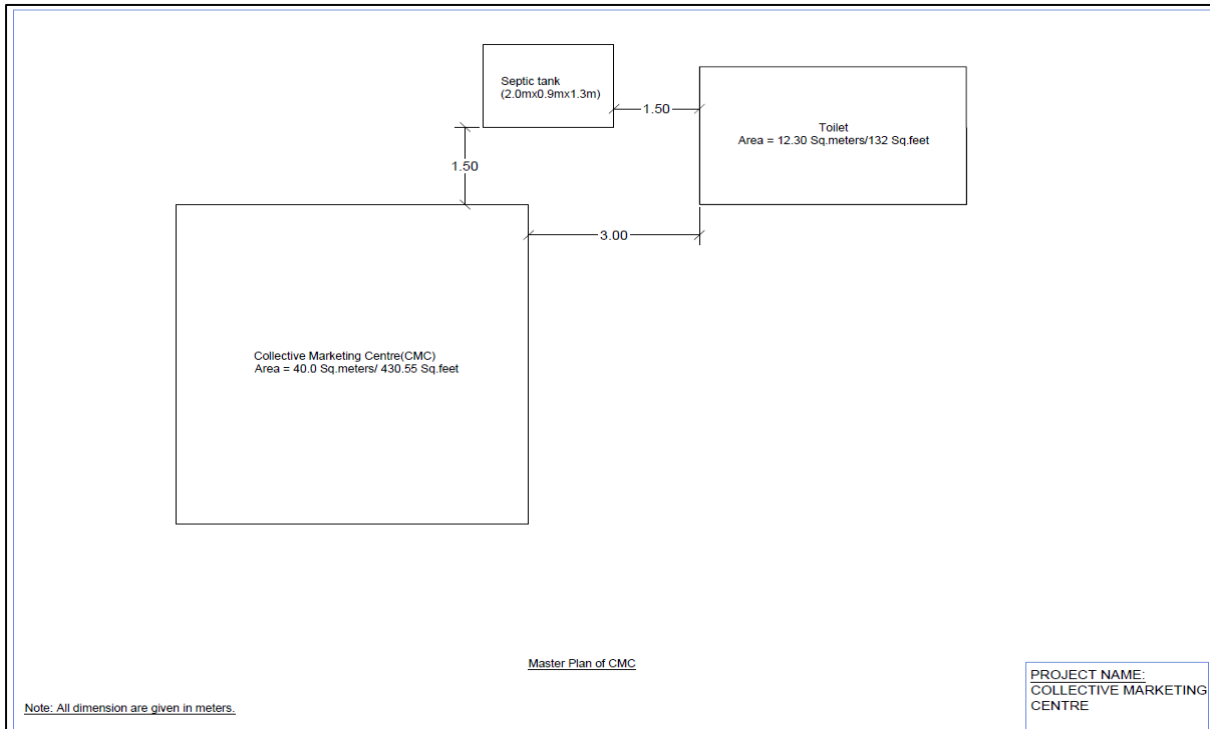

SECAP for Construction of Collective Marketing Centres under MLAMP, MBMA for South West Garo Hills

Appendix I: Checklist – Social, Environmental, and Climate risk screening

District: South West Garo Hills, Meghalaya	Block: 1. Zikzak	Integrated Village Cooperative Societies (IVCS): Zikzak 1. There will be 1 nos. of CMCs in this block	Date: 21 st October 2024		
Name of activity: Construction of Collective Marketing Centres (CMCs). Following will be the activities for each CMCs 1. Construction of CMC with storage: Area is 431 Sq. ft 2. Toilet: Area is 132 Sq. ft					
Name of the beneficiary or group: The beneficiaries will be the IVCS, farmers, CBOs, traders, among others					
Objective and usage of the CMCs: 1. The Collective Marketing Centres (CMC) is the primary farmgate infrastructure being set up under the M-LAMP to be the nodes for aggregation, processing and marketing of produce in the villages and clusters under the project 2. The CMC is a place for marketing of agricultural produce, in addition to being an input supply unit. The basic infrastructure will comprise of a collection space, drying area, retail area, storage area, office space and toilets. Other farm gate infrastructure like cold storage and food processing facilities will be set up in phase II based on need and performance of the CMC 3. The CMC is a one stop shop at the village level, which is co-owned by the members of the Integrated Village Cooperative Society (IVCS)/ Community Based Organisation (CBOs) who have contributed to this project 4. Create an awareness in the process of collective marketing and its merits 5. Initiate the system of aggregation and value addition at village Level 6. Ensure a transparent and good governance for marketing of produce by a collective 7. Enhance the skills of the stakeholder in areas of marketing and financial linkages					
Location of the CMCs:					
Sl. No	NAME OF DISTRICT	NAME OF BLOCK	IVCS	Latitude	Longitude
1	South West Garo Hills	Zikzak	Saliram IVCS Ltd.	25.3329	89.847507
Issue		Yes/No	If yes, suggest mitigation or adaptation measures to include in plan	Responsibility	
Social					
Are there any project targeted beneficiaries left?		No	The establishment of the CMCs will serve as an aggregation point for the village/community for all their agriculture produce. The CMCs will include all the beneficiaries such as IVCS, farmers, CBOs, traders, among others	1. Executive committee of the CMCs	

Do the proposed location and/or activities involve child or forced labour?	No	The activities will not involve any forced labour since the standard procurement process is being followed. There is a clause in the tender document which does not permit child labour and the contractor has to adhere to it	<ol style="list-style-type: none"> 1. DPMU 2. Executive committee of the CMC 3. Contractor
Is there any record of labour health and safety at the proposed location and/or activities?	No	The activity will be done through an open tendering process and there is already a clause in the tender document that the contractor has to adhere to the health and safety of the labours being engaged	<ol style="list-style-type: none"> 1. Contractor
Is private or public land acquisition necessary?	Yes	The location of the CMC is in existing community land. The permission/NOC from the local authorities/Dorbars shnong for utilization of the land for the construction of the CMCs is already obtained and available	<ol style="list-style-type: none"> 1. SPMU 2. DPMU
Will any tangible or intangible cultural heritage will be impacted?	No	There is no cultural heritage that will be impacted by this activity	<ol style="list-style-type: none"> 1. SPMU 2. DPMU
Environmental			
Does this activity increased use of chemical inputs?	No	<p>This is a minor civil work and will not include any usage of chemical inputs</p> <ol style="list-style-type: none"> 1. Construction of CMC with storage: Area is 431 Sq. ft 2. Toilet: Area is 132 Sq. ft 	<ol style="list-style-type: none"> 1. Contractor
Will there be issues with wastage management?	Yes	<p>There will be minimal impact with the waste management due to the size of the structure and the facility will be used only for storage of dry items including the aggregation point for the beneficiaries. However, the mitigation measures are:</p> <ol style="list-style-type: none"> i. Septic Tank and soak pit as budgeted in the BOQ ii. Huge dustbins will be placed in certain areas in the CMCs for the waste to be dumped iii. There is a vehicle arranged by the CMC committee to collect the dustbins every day or as per need iv. Any other requirements will be taken care through the cost of the additional contingencies as budgeted in the BOQ for this activity 	<ol style="list-style-type: none"> 1. DPMU 2. Executive committee of the CMC 3. Contractor
Will this activity increase pressure on water and forest resources?	No	The construction of the CMC is at a minor scale and does not cause	<ol style="list-style-type: none"> 1. DPMU

		any depletion and/or reduced flow of groundwater and/or surface water or impact any forest resources	<ol style="list-style-type: none"> 2. Executive committee of the CMC 3. Contractor
Are the proposed activities near or within a conservation or protected area?	No	The CMC is not near or within a conservation or protected area. The location of the CMC is in existing community land. The permission/NOC from the local authorities/Dorbars shnong for utilization of the land for the construction of the CMCs is already obtained and available	<ol style="list-style-type: none"> 1. DPMU 2. Executive committee of the CMC 3. Contractor
Climate			
Are the proposed activities exposed to impacts of climate change such as increasing temperature, pest and diseases, erratic rainfall etc?	Yes	<p>There is minimal impact, but due to the climatic conditions of the region following may be expected:</p> <ol style="list-style-type: none"> i. During summer the temperature may reach up to 35 deg. C. However, this sub-project also includes a storage facility, hence cold storages may be installed in future as per the requirements ii. Heavy Rainfall is expected during the monsoon season and the roof of the infrastructure will be a slanting-type design so that water will not be accumulated during rainy season. However, proper drainage facility will be constructed as per the requirement which is budgeted through the additional contingencies in the BOQ. Retaining walls may also be constructed if the need arises 	<ol style="list-style-type: none"> 1. DPMU 2. Executive committee of the CMC 3. Contractor
Are the proposed activities located in or near to climate hotspots (river bank, landslide or erosion areas)?	No	The construction of the CMC is not located in or near to climate hotspots (river bank, landslide or erosion areas)	<ol style="list-style-type: none"> 1. DPMU 2. Executive committee of the CMC

ESCMP Matrix of Construction of Collective Marketing Centers (CMCs)

Environment Aspects or Project Activities	Civil work/ Project activities	Potential Environmental/Social impacts	Mitigation/ Remedial Measures	Costs	Institutional Responsibility			
					Responsibility	Monitoring Action/ Indicator	Supervision	Frequency of implementation and/or monitoring
Natural Resources	Construction of: 1. Construction of CMC with storage: Area is 431 Sq. ft 2. Toilet facility: Area is 132 Sq. ft	1. Development happening in areas where little up-to-date information exists on sustainable yield/carrying capacity 2. Sub-project rely on surface water	1. The availability of the CMCs in this area will address the problem of carrying capacity and meet the increasing demand in agricultural produce and sustain the livelihood of the people 2. The construction of the CMC is at a minor scale and does	Design costs	Contractor ED, Technical, MBMA DPMU	1. Assessment on the new infrastructure to be build. To increase the facilities of the infrastructure if there are further requirements 2. Availability of water during the construction	ED - Technical, MBMA	During the construction phase and after the CMC is operational

			not cause any depletion and/or reduced flow of groundwater and/or surface water					
Climate Change Adaptation	<ol style="list-style-type: none"> 1. Use of climate-resilient design and materials 2. Elevated structures and collection space, drying area, retail area, office space facilities 3. Energy-efficient lighting and appliances 4. Storage facility 	<ol style="list-style-type: none"> 1. During summer the temperature may reached up to 35 deg. C 2. Heavy rainfall is expected during the monsoon season 	<ol style="list-style-type: none"> 1. Construction of a storage and drying area facility is part of the sub-project. Hence cold storages may be installed in future as per the requirements 2. The roof of the infrastructure will be a slanting-type design so that water 	Design costs	<ol style="list-style-type: none"> 1. ED, Technical - MBMA 2. Contractor 3. DPMU - MLAMP 	<ol style="list-style-type: none"> 1. Regular inspection of materials and infrastructures 	ED - Technical , MBMA	Prior and during the construction phase

			will not be accumulated during rainy season					
Human Rights	1. Fair labour practices 2. Accessibility for all vendors and customers	1. Labor exploitation 2. Discrimination	1. Implement fair wage policies 2. Ensure accessibility for people with disabilities	Design costs	IVCS committee	1. Labor audits 2. Accessibility checks	1. DPMU - MBMA 2. IVCS Committee	Prior and during the construction phase and after the market is operational
Health and Safety	1. Safe construction practices 2. Health facilities for market users	Occupational health and safety hazards to construction personnel & public	1. Provide safety training and equipment 2. Ensure availability of health services	Design costs	1. Contractor 2. MLAMP - DPMU	1. Incident reports 2. Health service utilization	1. Contractor 2. MLAMP - DPMU	Prior and during the construction phase and after the market is operational

SECAP for Construction of Collective Marketing Centres under MLAMP, MBMA for South West Khasi Hills

Appendix I: Checklist – Social, Environmental, and Climate risk screening

District: South West Khasi Hills, Meghalaya	Block: 1. Mawkyrwat 2. Ranikor	Integrated Village Cooperative Societies (IVCS): Mawkyrwat 1. There will be 5 nos. of CMCs in this block Ranikor There will be 1 nos. of CMCs in this block	Date: 21 st October 2024
Name of activity: Construction of Collective Marketing Centres (CMCs). Following will be the activities for each CMCs 1. Construction of CMC with storage: Area is 431 Sq. ft 2. Toilet: Area is 132 Sq. ft			
Name of the beneficiary or group: The beneficiaries will be the IVCS, farmers, CBOs, traders, among others			
Objective and usage of the CMCs: 1. The Collective Marketing Centres (CMC) is the primary farmgate infrastructure being set up under the M-LAMP to be the nodes for aggregation, processing and marketing of produce in the villages and clusters under the project 2. The CMC is a place for marketing of agricultural produce, in addition to being an input supply unit. The basic infrastructure will comprise of a collection space, drying area, retail area, storage area, office space and toilets. Other farm gate infrastructure like cold storage and food processing facilities will be set up in phase II based on need and performance of the CMC 3. The CMC is a one stop shop at the village level, which is co-owned by the members of the Integrated Village Cooperative Society (IVCS)/ Community Based Organisation (CBOs) who have contributed to this project 4. Create an awareness in the process of collective marketing and its merits 5. Initiate the system of aggregation and value addition at village Level 6. Ensure a transparent and good governance for marketing of produce by a collective 7. Enhance the skills of the stakeholder in areas of marketing and financial linkages			

Location of the CMCs:					
Sl. No	NAME OF DISTRICT	NAME OF BLOCK	IVCS	Latitude	Longitude
1	South West Khasi Hills	Mawkyrwat	Iamonlang IVCS	25.27031	91.226228
2	South West Khasi Hills	Mawkyrwat	Warsanlyngdoh IVCS	25.403933	91.202565
3	South West Khasi Hills	Mawkyrwat	Tyllilang IVCS	25.230214	91.3205
4	South West Khasi Hills	Ranikor	Raibah IVCS	25.25321333	91.43435667
5	South West Khasi Hills	Mawkyrwat	Rangblang Sohsyniang IVCS	25.413654	91.361515
6	South West Khasi Hills	Mawkyrwat	Shngimawlein Nongbrei Nongdom IVCS	25.422818	91.483656
Issue					
		Yes/No	If yes, suggest mitigation or adaptation measures to include in plan	Responsibility	
Social					
Are there any project targeted beneficiaries left?		No	The establishment of the CMCs will serve as an aggregation point for the village/community for all their agriculture produce. The CMCs will include all the beneficiaries such as IVCS, farmers, CBOs, traders, among others	1. Executive committee of the CMCs	
Do the proposed location and/or activities involve child or forced labour?		No	The activities will not involve any forced labour since the standard procurement process is being followed. There is a clause in the tender document which does not permit child labour and the contractor has to adhere to it	1. DPMU 2. Executive committee of the CMC 3. Contractor	
Is there any record of labour health and safety at the proposed location and/or activities?		No	The activity will be done through an open tendering process and there is already a clause in the tender document that the contractor has to adhere to the health and safety of the labours being engaged	1. Contractor	
Is private or public land acquisition necessary?		Yes	The location of the CMC is in existing community land. The permission/NOC from the local authorities/Dorbars shnong for utilization of the land for the construction of the CMCs is already obtained and available	1. SPMU 2. DPMU	
Will any tangible or intangible cultural heritage will be impacted?		No	There is no cultural heritage that will be impacted by this activity	1. SPMU 2. DPMU	
Environmental					
Does this activity increased use of chemical inputs?		No	This is a minor civil work and will not include any usage of chemical inputs	1. Contractor	

		<ol style="list-style-type: none"> 1. Construction of CMC with storage: Area is 431 Sq. ft 2. Toilet: Area is 132 Sq. ft 	
Will there be issues with wastage management?	Yes	<p>There will be minimal impact with the waste management due to the size of the structure and the facility will be used only for storage of dry items including the aggregation point for the beneficiaries. However, the mitigation measures are:</p> <ol style="list-style-type: none"> i. Septic Tank and soak pit as budgeted in the BOQ ii. Huge dustbins will be placed in certain areas in the CMCs for the waste to be dumped iii. There is a vehicle arranged by the CMC committee to collect the dustbins every day or as per need iv. Any other requirements will be taken care through the cost of the additional contingencies as budgeted in the BOQ for this activity 	<ol style="list-style-type: none"> 1. DPMU 2. Executive committee of the CMC 3. Contractor
Will this activity increase pressure on water and forest resources?	No	The construction of the CMC is at a minor scale and does not cause any depletion and/or reduced flow of groundwater and/or surface water or impact any forest resources	<ol style="list-style-type: none"> 1. DPMU 2. Executive committee of the CMC 3. Contractor
Are the proposed activities near or within a conservation or protected area?	No	The CMC is not near or within a conservation or protected area. The location of the CMC is in existing community land. The permission/NOC from the local authorities/Dorbars shnong for utilization of the land for the construction of the CMCs is already obtained and available	<ol style="list-style-type: none"> 1. DPMU 2. Executive committee of the CMC 3. Contractor
Climate			
Are the proposed activities exposed to impacts of climate change such as increasing temperature, pest and diseases, erratic rainfall etc?	Yes	<p>There is minimal impact, but due to the climatic conditions of the region following may be expected:</p> <ol style="list-style-type: none"> i. During summer the temperature may reach up to 28 deg. C. However, this sub-project also includes a storage facility, hence cold storages may be installed in future as per the requirements ii. Heavy Rainfall is expected during the monsoon season and the 	<ol style="list-style-type: none"> 1. DPMU 2. Executive committee of the CMC 3. Contractor

		<p>roof of the infrastructure will be a slanting-type design so that water will not be accumulated during rainy season. However, proper drainage facility will be constructed as per the requirement which is budgeted through the additional contingencies in the BOQ. Retaining walls may also be constructed if the need arises</p>	
<p>Are the proposed activities located in or near to climate hotspots (river bank, landslide or erosion areas)?</p>	No	<p>The construction of the CMC is not located in or near to climate hotspots (river bank, landslide or erosion areas)</p>	<ol style="list-style-type: none"> 1. DPMU 2. Executive committee of the CMC

ESCMP Matrix of Construction of Collective Marketing Centers (CMCs)

Environment Aspects or Project Activities	Civil work/ Project activities	Potential Environmental/Social impacts	Mitigation/ Remedial Measures	Costs	Institutional Responsibility			
					Responsibility	Monitoring Action/ Indicator	Supervision	Frequency of implementation and/or monitoring
Natural Resources	Construction of: 1. Construction of CMC with storage: Area is 431 Sq. ft 2. Toilet facility: Area is 132 Sq. ft	1. Development happening in areas where little up-to-date information exists on sustainable yield/carrying capacity 2. Sub-project rely on surface water	1. The availability of the CMCs in this area will address the problem of carrying capacity and meet the increasing demand in agricultural produce and sustain the livelihood of the people 2. The construction of the CMC is at a minor scale and does	Design costs	Contractor ED, Technical, MBMA DPMU	1. Assessment on the new infrastructure to be build. To increase the facilities of the infrastructure if there are further requirements 2. Availability of water during the construction	ED - Technical, MBMA	During the construction phase and after the CMC is operational

			not cause any depletion and/or reduced flow of groundwater and/or surface water					
Climate Change Adaptation	<ol style="list-style-type: none"> 1. Use of climate-resilient design and materials 2. Elevated structures and collection space, drying area, retail area, office space facilities 3. Energy-efficient lighting and appliances 4. Storage facility 	<ol style="list-style-type: none"> 1. During summer the temperature may reached up to 35 deg. C 2. Heavy rainfall is expected during the monsoon season 	<ol style="list-style-type: none"> 1. Construction of a storage and drying area facility is part of the sub-project. Hence cold storages may be installed in future as per the requirements 2. The roof of the infrastructure will be a slanting-type design so that water 	Design costs	<ol style="list-style-type: none"> 1. ED, Technical - MBMA 2. Contractor 3. DPMU - MLAMP 	<ol style="list-style-type: none"> 1. Regular inspection of materials and infrastructures 	ED - Technical , MBMA	Prior and during the construction phase

			will not be accumulated during rainy season					
Human Rights	1. Fair labour practices 2. Accessibility for all vendors and customers	1. Labor exploitation 2. Discrimination	1. Implement fair wage policies 2. Ensure accessibility for people with disabilities	Design costs	IVCS committee	1. Labor audits 2. Accessibility checks	1. DPMU - MBMA 2. IVCS Committee	Prior and during the construction phase and after the market is operational
Health and Safety	1. Safe construction practices 2. Health facilities for market users	Occupational health and safety hazards to construction personnel & public	1. Provide safety training and equipment 2. Ensure availability of health services	Design costs	1. Contractor 2. MLAMP - DPMU	1. Incident reports 2. Health service utilization	1. Contractor 2. MLAMP - DPMU	Prior and during the construction phase and after the market is operational

Master Plan and Drawing of the CMC:

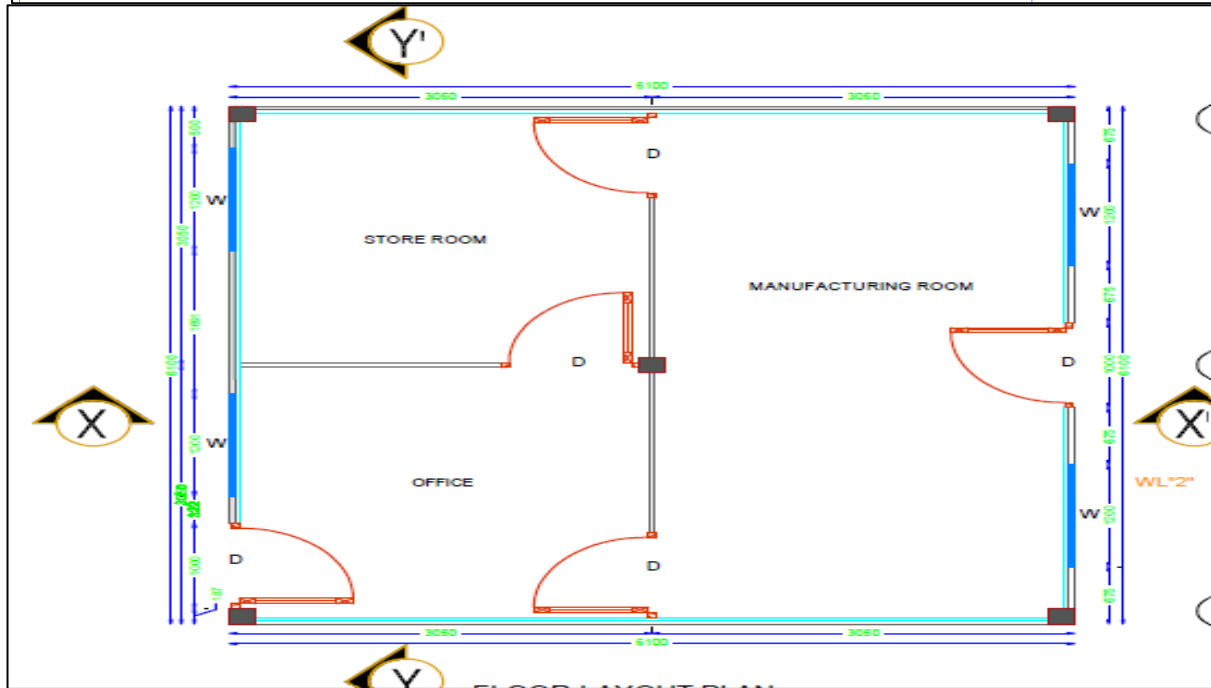
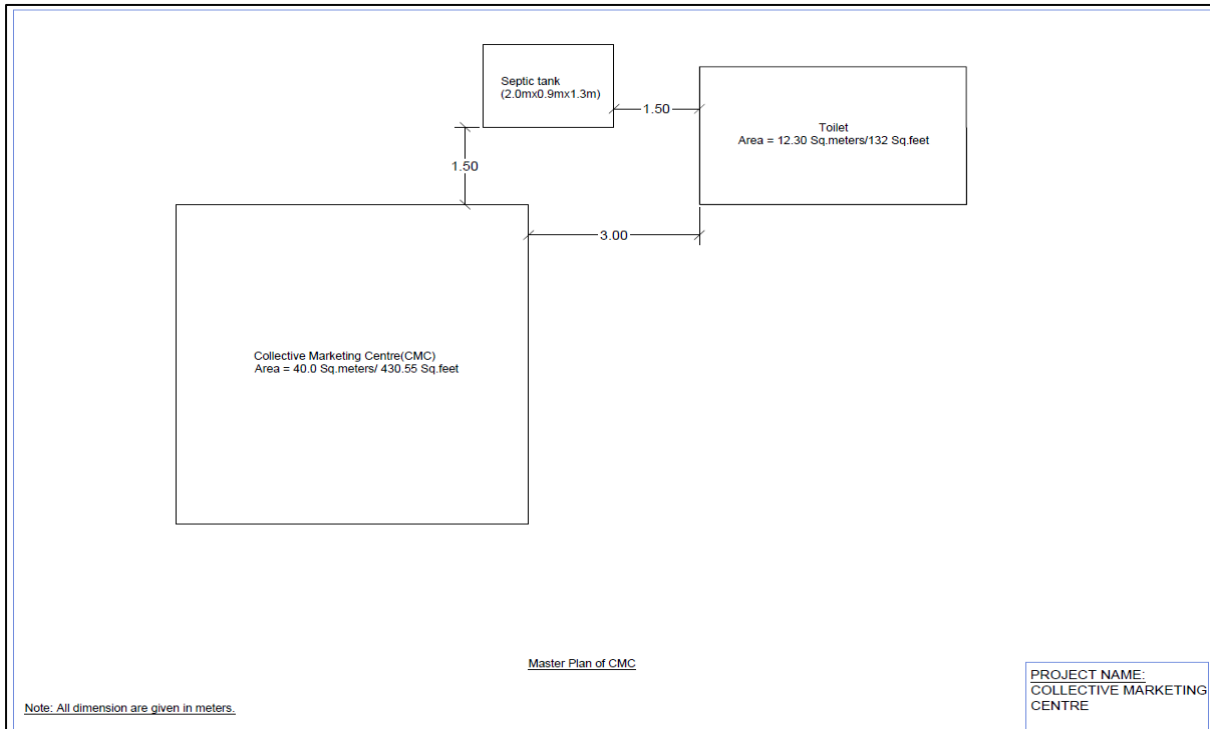

SECAP for Construction of Collective Marketing Centres under MLAMP, MBMA for West Garo Hills

Appendix I: Checklist – Social, Environmental, and Climate risk screening

District: West Garo Hills, Meghalaya	Block: 1. Demdema	Integrated Village Cooperative Societies (IVCS): Demdema 1. There will be 2 nos. of CMCs in this block	Date: 21 st October 2024		
Name of activity: Construction of Collective Marketing Centres (CMCs). Following will be the activities for each CMCs 1. Construction of CMC with storage: Area is 431 Sq. ft 2. Toilet: Area is 132 Sq. ft					
Name of the beneficiary or group: The beneficiaries will be the IVCS, farmers, CBOs, traders, among others					
Objective and usage of the CMCs: 1. The Collective Marketing Centres (CMC) is the primary farmgate infrastructure being set up under the M-LAMP to be the nodes for aggregation, processing and marketing of produce in the villages and clusters under the project 2. The CMC is a place for marketing of agricultural produce, in addition to being an input supply unit. The basic infrastructure will comprise of a collection space, drying area, retail area, storage area, office space and toilets. Other farm gate infrastructure like cold storage and food processing facilities will be set up in phase II based on need and performance of the CMC 3. The CMC is a one stop shop at the village level, which is co-owned by the members of the Integrated Village Cooperative Society (IVCS)/ Community Based Organisation (CBOs) who have contributed to this project 4. Create an awareness in the process of collective marketing and its merits 5. Initiate the system of aggregation and value addition at village Level 6. Ensure a transparent and good governance for marketing of produce by a collective 7. Enhance the skills of the stakeholder in areas of marketing and financial linkages					
Location of the CMCs:					
Sl. No	NAME OF DISTRICT	NAME OF BLOCK	IVCS	Latitude	Longitude
1	West Garo Hills	Demdema	Beautiful IVCS Ltd.	25.871012	90.062676
2	West Garo Hills	Demdema	Khurang IVCS Ltd.	25.868377	90.068796
Issue		Yes/No	If yes, suggest mitigation or adaptation measures to include in plan		Responsibility
Social					
Are there any project targeted beneficiaries left?		No	The establishment of the CMCs will serve as an aggregation point for the village/community for all their agriculture produce. The CMCs will include all the beneficiaries such as IVCS,		1. Executive committee of the CMCs

		farmers, CBOs, traders, among others	
Do the proposed location and/or activities involve child or forced labour?	No	The activities will not involve any forced labour since the standard procurement process is being followed. There is a clause in the tender document which does not permit child labour and the contractor has to adhere to it	1. DPMU 2. Executive committee of the CMC 3. Contractor
Is there any record of labour health and safety at the proposed location and/or activities?	No	The activity will be done through an open tendering process and there is already a clause in the tender document that the contractor has to adhere to the health and safety of the labours being engaged	1. Contractor
Is private or public land acquisition necessary?	Yes	The location of the CMC is in existing community land. The permission/NOC from the local authorities/Dorbars shnong for utilization of the land for the construction of the CMCs is already obtained and available	1. SPMU 2. DPMU
Will any tangible or intangible cultural heritage will be impacted?	No	There is no cultural heritage that will be impacted by this activity	1. SPMU 2. DPMU
Environmental			
Does this activity increased use of chemical inputs?	No	This is a minor civil work and will not include any usage of chemical inputs 1. Construction of CMC with storage: Area is 431 Sq. ft 2. Toilet: Area is 132 Sq. ft	1. Contractor
Will there be issues with wastage management?	Yes	There will be minimal impact with the waste management due to the size of the structure and the facility will be used only for storage of dry items including the aggregation point for the beneficiaries. However, the mitigation measures are: i. Septic Tank and soak pit as budgeted in the BOQ ii. Huge dustbins will be placed in certain areas in the CMCs for the waste to be dumped iii. There is a vehicle arranged by the CMC committee to collect the dustbins every day or as per need iv. Any other requirements will be taken care through the cost of the additional contingencies as budgeted in the BOQ for this activity	1. DPMU 2. Executive committee of the CMC 3. Contractor

Will this activity increase pressure on water and forest resources?	No	The construction of the CMC is at a minor scale and does not cause any depletion and/or reduced flow of groundwater and/or surface water or impact any forest resources	<ol style="list-style-type: none"> 1. DPMU 2. Executive committee of the CMC 3. Contractor
Are the proposed activities near or within a conservation or protected area?	No	The CMC is not near or within a conservation or protected area. The location of the CMC is in existing community land. The permission/NOC from the local authorities/Dorbars shnong for utilization of the land for the construction of the CMCs is already obtained and available	<ol style="list-style-type: none"> 1. DPMU 2. Executive committee of the CMC 3. Contractor
Climate			
Are the proposed activities exposed to impacts of climate change such as increasing temperature, pest and diseases, erratic rainfall etc?	Yes	<p>There is minimal impact, but due to the climatic conditions of the region following may be expected:</p> <ol style="list-style-type: none"> i. During summer the temperature may reach up to 35 deg. C. However, this sub-project also includes a storage facility, hence cold storages may be installed in future as per the requirements ii. Heavy Rainfall is expected during the monsoon season and the roof of the infrastructure will be a slanting-type design so that water will not be accumulated during rainy season. However, proper drainage facility will be constructed as per the requirement which is budgeted through the additional contingencies in the BOQ. Retaining walls may also be constructed if the need arises 	<ol style="list-style-type: none"> 1. DPMU 2. Executive committee of the CMC 3. Contractor
Are the proposed activities located in or near to climate hotspots (river bank, landslide or erosion areas)?	No	The construction of the CMC is not located in or near to climate hotspots (river bank, landslide or erosion areas)	<ol style="list-style-type: none"> 1. DPMU 2. Executive committee of the CMC

ESCMP Matrix of Construction of Collective Marketing Centers (CMCs)

Environment Aspects or Project Activities	Civil work/ Project activities	Potential Environmental/Social impacts	Mitigation/ Remedial Measures	Costs	Institutional Responsibility			
					Responsibility	Monitoring Action/ Indicator	Supervision	Frequency of implementation and/or monitoring
Natural Resources	Construction of: 1. Construction of CMC with storage: Area is 431 Sq. ft 2. Toilet facility: Area is 132 Sq. ft	1. Development happening in areas where little up-to-date information exists on sustainable yield/carrying capacity 2. Sub-project rely on surface water	1. The availability of the CMCs in this area will address the problem of carrying capacity and meet the increasing demand in agricultural produce and sustain the livelihood of the people 2. The construction of the CMC is at a minor scale and does	Design costs	Contractor ED, Technical, MBMA DPMU	1. Assessment on the new infrastructure to be build. To increase the facilities of the infrastructure if there are further requirements 2. Availability of water during the construction	ED - Technical, MBMA	During the construction phase and after the CMC is operational

			not cause any depletion and/or reduced flow of groundwater and/or surface water					
Climate Change Adaptation	<ol style="list-style-type: none"> 1. Use of climate-resilient design and materials 2. Elevated structures and collection space, drying area, retail area, office space facilities 3. Energy-efficient lighting and appliances 4. Storage facility 	<ol style="list-style-type: none"> 1. During summer the temperature may reached up to 35 deg. C 2. Heavy rainfall is expected during the monsoon season 	<ol style="list-style-type: none"> 1. Construction of a storage and drying area facility is part of the sub-project. Hence cold storages may be installed in future as per the requirements 2. The roof of the infrastructure will be a slanting-type design so that water 	Design costs	<ol style="list-style-type: none"> 1. ED, Technical - MBMA 2. Contractor 3. DPMU - MLAMP 	<ol style="list-style-type: none"> 1. Regular inspection of materials and infrastructures 	ED - Technical , MBMA	Prior and during the construction phase

			will not be accumulated during rainy season					
Human Rights	1. Fair labour practices 2. Accessibility for all vendors and customers	1. Labor exploitation 2. Discrimination	1. Implement fair wage policies 2. Ensure accessibility for people with disabilities	Design costs	IVCS committee	1. Labor audits 2. Accessibility checks	1. DPMU - MBMA 2. IVCS Committee	Prior and during the construction phase and after the market is operational
Health and Safety	1. Safe construction practices 2. Health facilities for market users	Occupational health and safety hazards to construction personnel & public	1. Provide safety training and equipment 2. Ensure availability of health services	Design costs	1. Contractor 2. MLAMP - DPMU	1. Incident reports 2. Health service utilization	1. Contractor 2. MLAMP - DPMU	Prior and during the construction phase and after the market is operational

Master Plan and Drawing of the CMC:

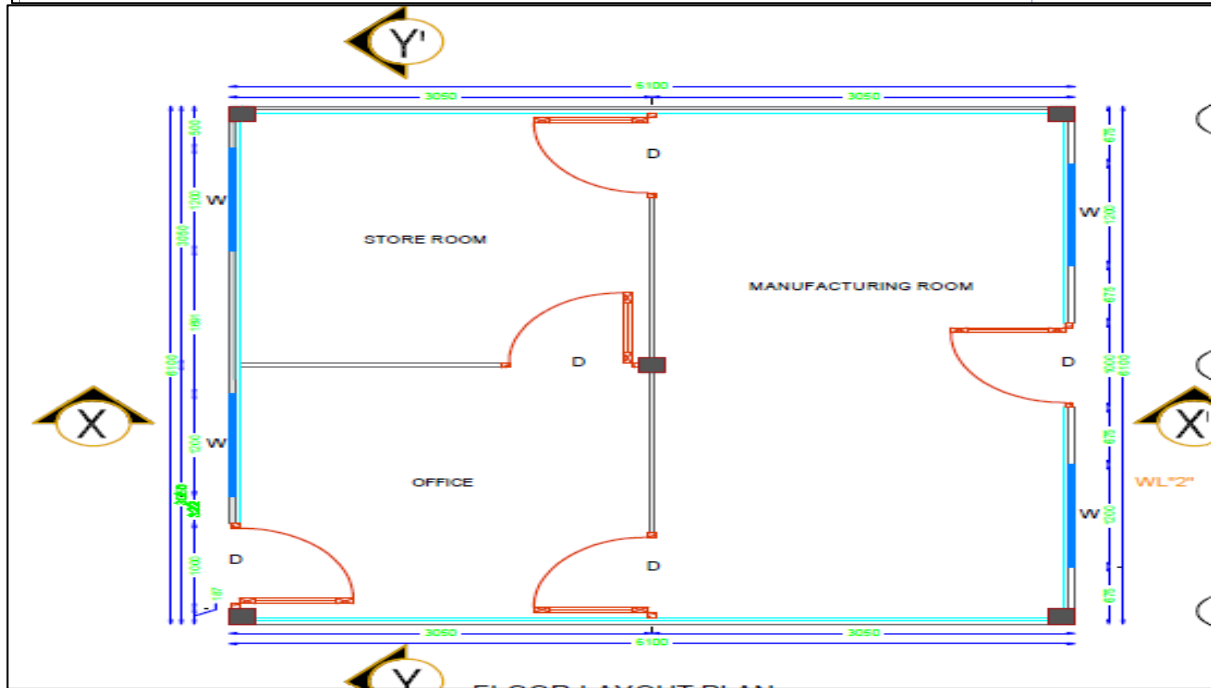
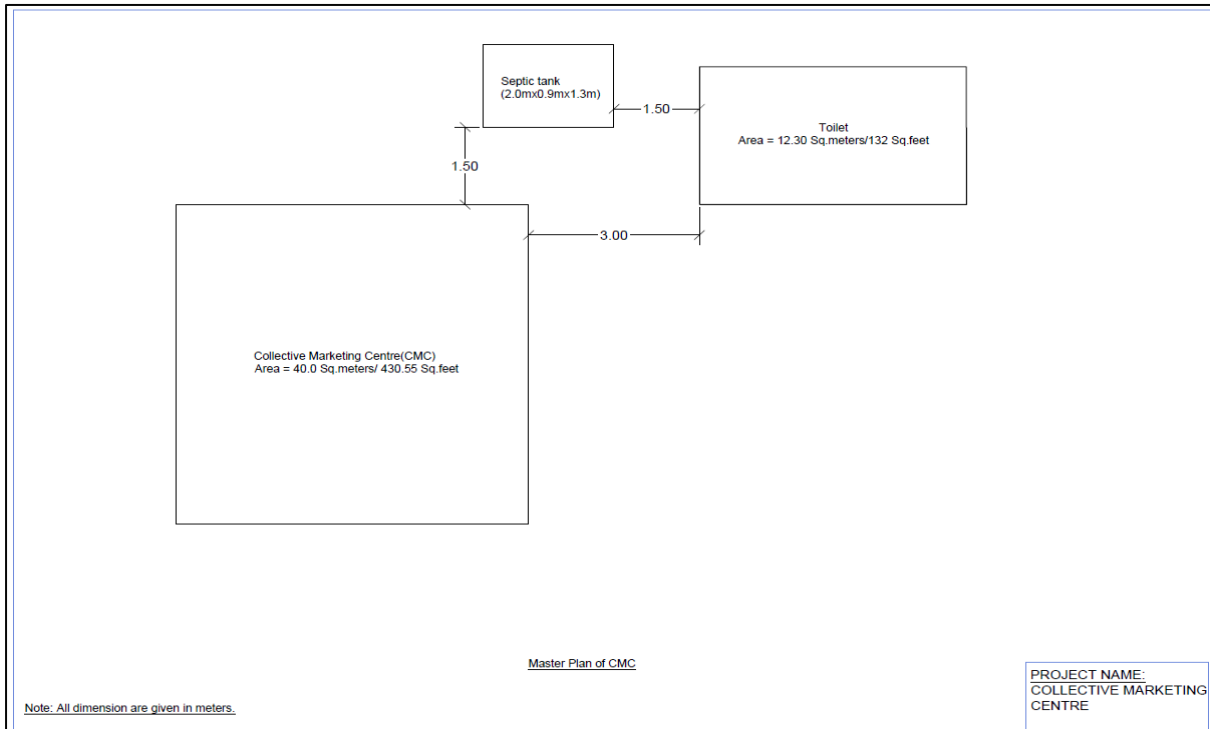

SECAP for Construction of Collective Marketing Centres under MLAMP, MBMA for West Jaintia Hills

Appendix I: Checklist – Social, Environmental, and Climate risk screening

District: West Jaintia Hills, Meghalaya	Block: 1. Amlarem	Integrated Cooperative Societies (IVCS): Thadlaskein 1. There will be 1 nos. of CMCs in this block Amlarem There will be 3 nos. of CMCs in this block	Village Societies	Date: 21 st October 2024	
Name of activity: Construction of Collective Marketing Centres (CMCs). Following will be the activities for each CMCs 1. Construction of CMC with storage: Area is 431 Sq. ft 2. Toilet: Area is 132 Sq. ft					
Name of the beneficiary or group: The beneficiaries will be the IVCS, farmers, CBOs, traders, among others					
Objective and usage of the CMCs: 1. The Collective Marketing Centres (CMC) is the primary farmgate infrastructure being set up under the M-LAMP to be the nodes for aggregation, processing and marketing of produce in the villages and clusters under the project 2. The CMC is a place for marketing of agricultural produce, in addition to being an input supply unit. The basic infrastructure will comprise of a collection space, drying area, retail area, storage area, office space and toilets. Other farm gate infrastructure like cold storage and food processing facilities will be set up in phase II based on need and performance of the CMC 3. The CMC is a one stop shop at the village level, which is co-owned by the members of the Integrated Village Cooperative Society (IVCS)/ Community Based Organisation (CBOs) who have contributed to this project 4. Create an awareness in the process of collective marketing and its merits 5. Initiate the system of aggregation and value addition at village Level 6. Ensure a transparent and good governance for marketing of produce by a collective 7. Enhance the skills of the stakeholder in areas of marketing and financial linkages					
Location of the CMCs:					
Sl. No	NAME OF DISTRICT	NAME OF BLOCK	IVCS	Latitude	Longitude
1	West Jaintia Hills	Amlarem	Padu Bah IVCS	25.277426	92.028419
Issue		Yes/No	If yes, suggest mitigation or adaptation measures to include in plan		Responsibility
Social					
Are there any project targeted beneficiaries left?		No	The establishment of the CMCs will serve as an aggregation point for the village/community for all their agriculture produce. The CMCs will include all the		1. Executive committee of the CMCs

		beneficiaries such as IVCS, farmers, CBOs, traders, among others	
Do the proposed location and/or activities involve child or forced labour?	No	The activities will not involve any forced labour since the standard procurement process is being followed. There is a clause in the tender document which does not permit child labour and the contractor has to adhere to it	1. DPMU 2. Executive committee of the CMC 3. Contractor
Is there any record of labour health and safety at the proposed location and/or activities?	No	The activity will be done through an open tendering process and there is already a clause in the tender document that the contractor has to adhere to the health and safety of the labours being engaged	1. Contractor
Is private or public land acquisition necessary?	Yes	The location of the CMC is in existing community land. The permission/NOC from the local authorities/Dorbars shnong for utilization of the land for the construction of the CMCs is already obtained and available	1. SPMU 2. DPMU
Will any tangible or intangible cultural heritage will be impacted?	No	There is no cultural heritage that will be impacted by this activity	1. SPMU 2. DPMU
Environmental			
Does this activity increased use of chemical inputs?	No	This is a minor civil work and will not include any usage of chemical inputs 1. Construction of CMC with storage: Area is 431 Sq. ft 2. Toilet: Area is 132 Sq. ft	1. Contractor
Will there be issues with wastage management?	Yes	There will be minimal impact with the waste management due to the size of the structure and the facility will be used only for storage of dry items including the aggregation point for the beneficiaries. However, the mitigation measures are: i. Septic Tank and soak pit as budgeted in the BOQ ii. Huge dustbins will be placed in certain areas in the CMCs for the waste to be dumped iii. There is a vehicle arranged by the CMC committee to collect the dustbins every day or as per need iv. Any other requirements will be taken care through the cost of the additional contingencies as budgeted in the BOQ for this activity	1. DPMU 2. Executive committee of the CMC 3. Contractor

Will this activity increase pressure on water and forest resources?	No	The construction of the CMC is at a minor scale and does not cause any depletion and/or reduced flow of groundwater and/or surface water or impact any forest resources	<ol style="list-style-type: none"> 1. DPMU 2. Executive committee of the CMC 3. Contractor
Are the proposed activities near or within a conservation or protected area?	No	The CMC is not near or within a conservation or protected area. The location of the CMC is in existing community land. The permission/NOC from the local authorities/Dorbars shnong for utilization of the land for the construction of the CMCs is already obtained and available	<ol style="list-style-type: none"> 1. DPMU 2. Executive committee of the CMC 3. Contractor
Climate			
Are the proposed activities exposed to impacts of climate change such as increasing temperature, pest and diseases, erratic rainfall etc?	Yes	<p>There is minimal impact, but due to the climatic conditions of the region following may be expected:</p> <ol style="list-style-type: none"> i. During summer the temperature may reach up to 28 deg. C. However, this sub-project also includes a storage facility, hence cold storages may be installed in future as per the requirements ii. Heavy Rainfall is expected during the monsoon season and the roof of the infrastructure will be a slanting-type design so that water will not be accumulated during rainy season. However, proper drainage facility will be constructed as per the requirement which is budgeted through the additional contingencies in the BOQ. Retaining walls may also be constructed if the need arises 	<ol style="list-style-type: none"> 1. DPMU 2. Executive committee of the CMC 3. Contractor
Are the proposed activities located in or near to climate hotspots (river bank, landslide or erosion areas)?	No	The construction of the CMC is not located in or near to climate hotspots (river bank, landslide or erosion areas)	<ol style="list-style-type: none"> 1. DPMU 2. Executive committee of the CMC

ESCMP Matrix of Construction of Collective Marketing Centers (CMCs)

Environment Aspects or Project Activities	Civil work/ Project activities	Potential Environmental/Social impacts	Mitigation/ Remedial Measures	Costs	Institutional Responsibility			
					Responsibility	Monitoring Action/ Indicator	Supervision	Frequency of implementation and/or monitoring
Natural Resources	Construction of: 1. Construction of CMC with storage: Area is 431 Sq. ft 2. Toilet facility: Area is 132 Sq. ft	1. Development happening in areas where little up-to-date information exists on sustainable yield/carrying capacity 2. Sub-project rely on surface water	1. The availability of the CMCs in this area will address the problem of carrying capacity and meet the increasing demand in agricultural produce and sustain the livelihood of the people 2. The construction of the CMC is at a minor scale and does	Design costs	Contractor ED, Technical, MBMA DPMU	1. Assessment on the new infrastructure to be build. To increase the facilities of the infrastructure if there are further requirements 2. Availability of water during the construction	ED - Technical, MBMA	During the construction phase and after the CMC is operational

			not cause any depletion and/or reduced flow of groundwater and/or surface water					
Climate Change Adaptation	<ol style="list-style-type: none"> 1. Use of climate-resilient design and materials 2. Elevated structures and collection space, drying area, retail area, office space facilities 3. Energy-efficient lighting and appliances 4. Storage facility 	<ol style="list-style-type: none"> 1. During summer the temperature may reached up to 35 deg. C 2. Heavy rainfall is expected during the monsoon season 	<ol style="list-style-type: none"> 1. Construction of a storage and drying area facility is part of the sub-project. Hence cold storages may be installed in future as per the requirements 2. The roof of the infrastructure will be a slanting-type design so that water 	Design costs	<ol style="list-style-type: none"> 1. ED, Technical - MBMA 2. Contractor 3. DPMU - MLAMP 	<ol style="list-style-type: none"> 1. Regular inspection of materials and infrastructure 	ED - Technical , MBMA	Prior and during the construction phase

			will not be accumulated during rainy season					
Human Rights	1. Fair labour practices 2. Accessibility for all vendors and customers	1. Labor exploitation 2. Discrimination	1. Implement fair wage policies 2. Ensure accessibility for people with disabilities	Design costs	IVCS committee	1. Labor audits 2. Accessibility checks	1. DPMU - MBMA 2. IVCS Committee	Prior and during the construction phase and after the market is operational
Health and Safety	1. Safe construction practices 2. Health facilities for market users	Occupational health and safety hazards to construction personnel & public	1. Provide safety training and equipment 2. Ensure availability of health services	Design costs	1. Contractor 2. MLAMP - DPMU	1. Incident reports 2. Health service utilization	1. Contractor 2. MLAMP - DPMU	Prior and during the construction phase and after the market is operational

Master Plan and Drawing of the CMC:

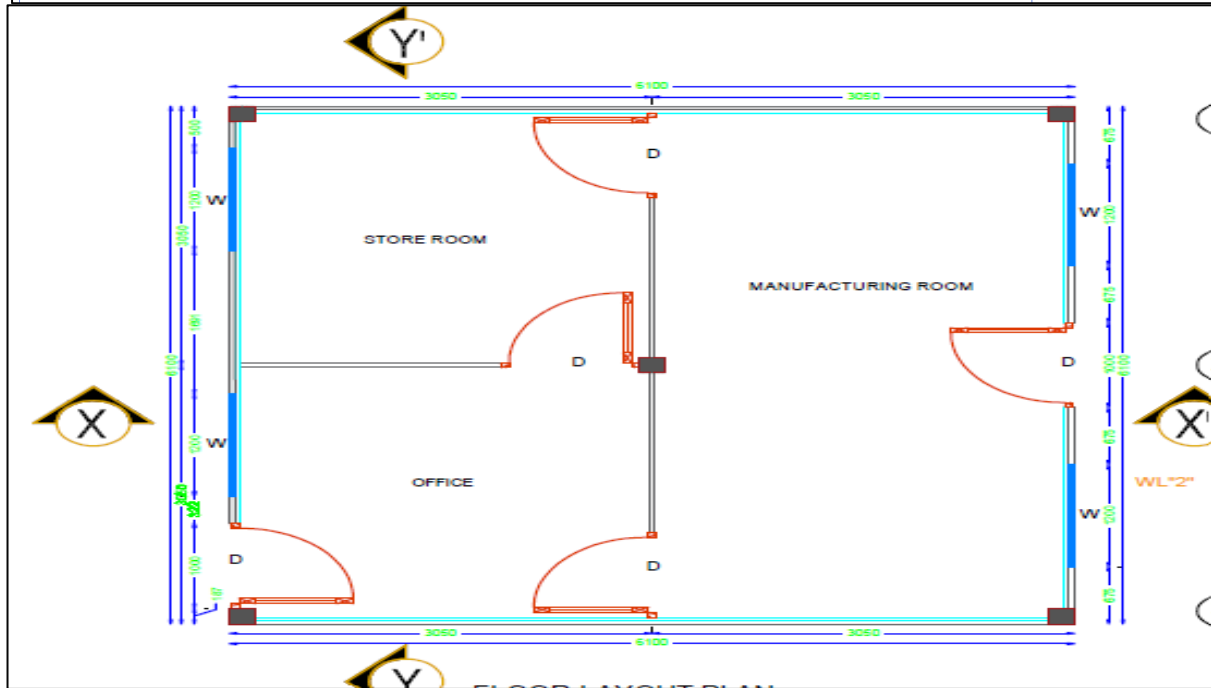
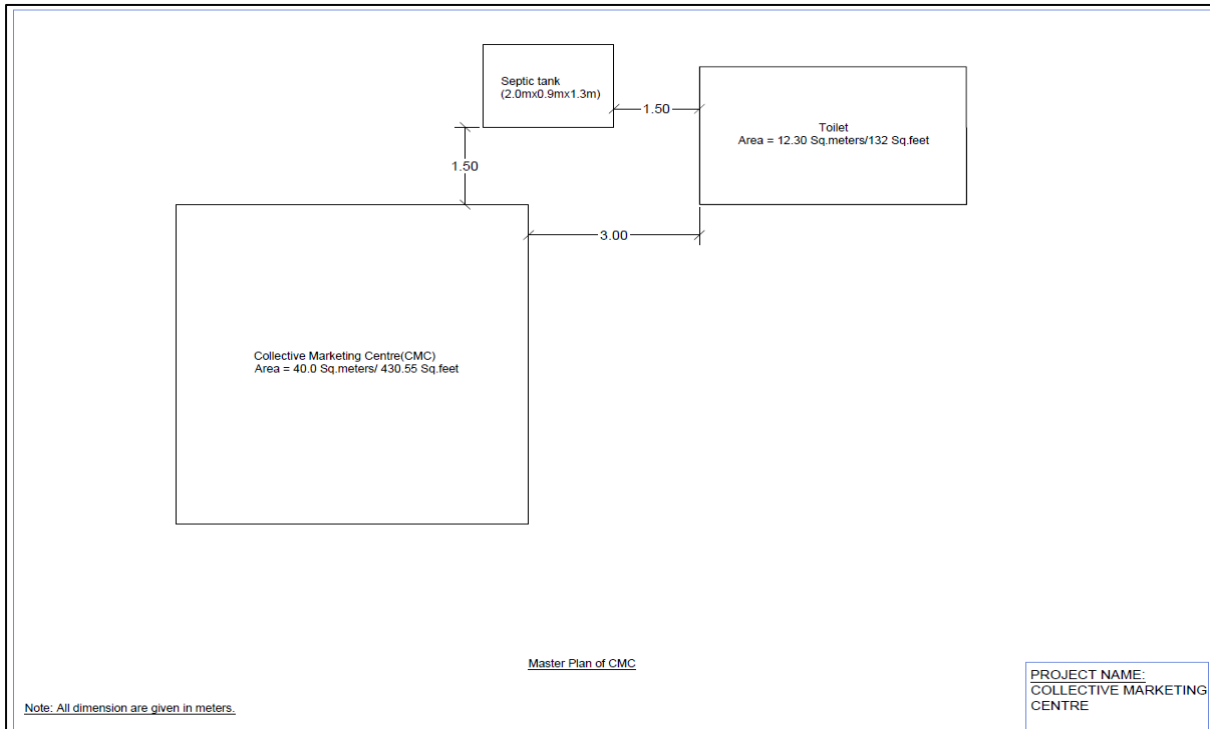

SECAP for Construction of Collective Marketing Centres under MLAMP, MBMA for West Khasi Hills

Appendix I: Checklist – Social, Environmental, and Climate risk screening

District: West Khasi Hills, Meghalaya	Block: 1. Mawshynrut	Integrated Village Cooperative Societies (IVCS): Mawshynrut 1. There will be 3 nos. of CMCs in this block	Date: 21 st October 2024		
Name of activity: Construction of Collective Marketing Centres (CMCs). Following will be the activities for each CMCs 1. Construction of CMC with storage: Area is 431 Sq. ft 2. Toilet: Area is 132 Sq. ft					
Name of the beneficiary or group: The beneficiaries will be the IVCS, farmers, CBOs, traders, among others					
Objective and usage of the CMCs: 1. The Collective Marketing Centres (CMC) is the primary farmgate infrastructure being set up under the M-LAMP to be the nodes for aggregation, processing and marketing of produce in the villages and clusters under the project 2. The CMC is a place for marketing of agricultural produce, in addition to being an input supply unit. The basic infrastructure will comprise of a collection space, drying area, retail area, storage area, office space and toilets. Other farm gate infrastructure like cold storage and food processing facilities will be set up in phase II based on need and performance of the CMC 3. The CMC is a one stop shop at the village level, which is co-owned by the members of the Integrated Village Cooperative Society (IVCS)/ Community Based Organisation (CBOs) who have contributed to this project 4. Create an awareness in the process of collective marketing and its merits 5. Initiate the system of aggregation and value addition at village Level 6. Ensure a transparent and good governance for marketing of produce by a collective 7. Enhance the skills of the stakeholder in areas of marketing and financial linkages					
Location of the CMCs:					
Sl. No	NAME OF DISTRICT	NAME OF BLOCK	IVCS	Latitude	Longitude
1	West Khasi Hills	Mawshynrut	Sangriang IVCS	25.465653	91.241434
2	West Khasi Hills	Mawshynrut	Nonglwai IVCS	25.461021	91.328049
3	West Khasi Hills	Mawshynrut	Seinduli IVCS	25.660837	91.14363
Issue		Yes/No	If yes, suggest mitigation or adaptation measures to include in plan	Responsibility	
Social					
Are there any project targeted beneficiaries left?		No	The establishment of the CMCs will serve as an aggregation point for the village/community for all their agriculture produce. The CMCs will include all the beneficiaries such as IVCS,	1. Executive committee of the CMCs	

		farmers, CBOs, traders, among others	
Do the proposed location and/or activities involve child or forced labour?	No	The activities will not involve any forced labour since the standard procurement process is being followed. There is a clause in the tender document which does not permit child labour and the contractor has to adhere to it	1. DPMU 2. Executive committee of the CMC 3. Contractor
Is there any record of labour health and safety at the proposed location and/or activities?	No	The activity will be done through an open tendering process and there is already a clause in the tender document that the contractor has to adhere to the health and safety of the labours being engaged	1. Contractor
Is private or public land acquisition necessary?	Yes	The location of the CMC is in existing community land. The permission/NOC from the local authorities/Dorbars shnong for utilization of the land for the construction of the CMCs is already obtained and available	1. SPMU 2. DPMU
Will any tangible or intangible cultural heritage will be impacted?	No	There is no cultural heritage that will be impacted by this activity	1. SPMU 2. DPMU
Environmental			
Does this activity increased use of chemical inputs?	No	This is a minor civil work and will not include any usage of chemical inputs 1. Construction of CMC with storage: Area is 431 Sq. ft 2. Toilet: Area is 132 Sq. ft	1. Contractor
Will there be issues with wastage management?	Yes	There will be minimal impact with the waste management due to the size of the structure and the facility will be used only for storage of dry items including the aggregation point for the beneficiaries. However, the mitigation measures are: i. Septic Tank and soak pit as budgeted in the BOQ ii. Huge dustbins will be placed in certain areas in the CMCs for the waste to be dumped iii. There is a vehicle arranged by the CMC committee to collect the dustbins every day or as per need iv. Any other requirements will be taken care through the cost of the additional contingencies as budgeted in the BOQ for this activity	1. DPMU 2. Executive committee of the CMC 3. Contractor

Will this activity increase pressure on water and forest resources?	No	The construction of the CMC is at a minor scale and does not cause any depletion and/or reduced flow of groundwater and/or surface water or impact any forest resources	<ol style="list-style-type: none"> 1. DPMU 2. Executive committee of the CMC 3. Contractor
Are the proposed activities near or within a conservation or protected area?	No	The CMC is not near or within a conservation or protected area. The location of the CMC is in existing community land. The permission/NOC from the local authorities/Dorbars shnong for utilization of the land for the construction of the CMCs is already obtained and available	<ol style="list-style-type: none"> 1. DPMU 2. Executive committee of the CMC 3. Contractor
Climate			
Are the proposed activities exposed to impacts of climate change such as increasing temperature, pest and diseases, erratic rainfall etc?	Yes	<p>There is minimal impact, but due to the climatic conditions of the region following may be expected:</p> <ol style="list-style-type: none"> i. During summer the temperature may reach up to 28 deg. C. However, this sub-project also includes a storage facility, hence cold storages may be installed in future as per the requirements ii. Heavy Rainfall is expected during the monsoon season and the roof of the infrastructure will be a slanting-type design so that water will not be accumulated during rainy season. However, proper drainage facility will be constructed as per the requirement which is budgeted through the additional contingencies in the BOQ. Retaining walls may also be constructed if the need arises 	<ol style="list-style-type: none"> 1. DPMU 2. Executive committee of the CMC 3. Contractor
Are the proposed activities located in or near to climate hotspots (river bank, landslide or erosion areas)?	No	The construction of the CMC is not located in or near to climate hotspots (river bank, landslide or erosion areas)	<ol style="list-style-type: none"> 1. DPMU 2. Executive committee of the CMC

ESCMP Matrix of Construction of Collective Marketing Centers (CMCs)

Environment Aspects or Project Activities	Civil work/ Project activities	Potential Environmental/Social impacts	Mitigation/ Remedial Measures	Costs	Institutional Responsibility			
					Responsibility	Monitoring Action/ Indicator	Supervision	Frequency of implementation and/or monitoring
Natural Resources	Construction of: 1. Construction of CMC with storage: Area is 431 Sq. ft 2. Toilet facility: Area is 132 Sq. ft	1. Development happening in areas where little up-to-date information exists on sustainable yield/carrying capacity 2. Sub-project rely on surface water	1. The availability of the CMCs in this area will address the problem of carrying capacity and meet the increasing demand in agricultural produce and sustain the livelihood of the people 2. The construction of the CMC is at a minor scale and does	Design costs	Contractor ED, Technical, MBMA DPMU	1. Assessment on the new infrastructure to be build. To increase the facilities of the infrastructure if there are further requirements 2. Availability of water during the construction	ED - Technical, MBMA	During the construction phase and after the CMC is operational

			not cause any depletion and/or reduced flow of groundwater and/or surface water					
Climate Change Adaptation	<ol style="list-style-type: none"> 1. Use of climate-resilient design and materials 2. Elevated structures and collection space, drying area, retail area, office space facilities 3. Energy-efficient lighting and appliances 4. Storage facility 	<ol style="list-style-type: none"> 1. During summer the temperature may reached up to 35 deg. C 2. Heavy rainfall is expected during the monsoon season 	<ol style="list-style-type: none"> 1. Construction of a storage and drying area facility is part of the sub-project. Hence cold storages may be installed in future as per the requirements 2. The roof of the infrastructure will be a slanting-type design so that water 	Design costs	<ol style="list-style-type: none"> 1. ED, Technical - MBMA 2. Contractor 3. DPMU - MLAMP 	<ol style="list-style-type: none"> 1. Regular inspection of materials and infrastructures 	ED - Technical , MBMA	Prior and during the construction phase

			will not be accumulated during rainy season					
Human Rights	1. Fair labour practices 2. Accessibility for all vendors and customers	1. Labor exploitation 2. Discrimination	1. Implement fair wage policies 2. Ensure accessibility for people with disabilities	Design costs	IVCS committee	1. Labor audits 2. Accessibility checks	1. DPMU - MBMA 2. IVCS Committee	Prior and during the construction phase and after the market is operational
Health and Safety	1. Safe construction practices 2. Health facilities for market users	Occupational health and safety hazards to construction personnel & public	1. Provide safety training and equipment 2. Ensure availability of health services	Design costs	1. Contractor 2. MLAMP - DPMU	1. Incident reports 2. Health service utilization	1. Contractor 2. MLAMP - DPMU	Prior and during the construction phase and after the market is operational

Master Plan and Drawing of the CMC:

